

KANIE

SECTOR: HEALTH



ABOUT US



Who We Are

We are a privately owned commercial construction company active in all sectors of the industry. With a turnover in excess of \$800 million and over 400 full time employees, we operate throughout the east coast of Australia and overseas from offices in Melbourne, Sydney, Brisbane and Canberra.

‘Our success is recognised in the way we achieve, as much as what we achieve.’



People

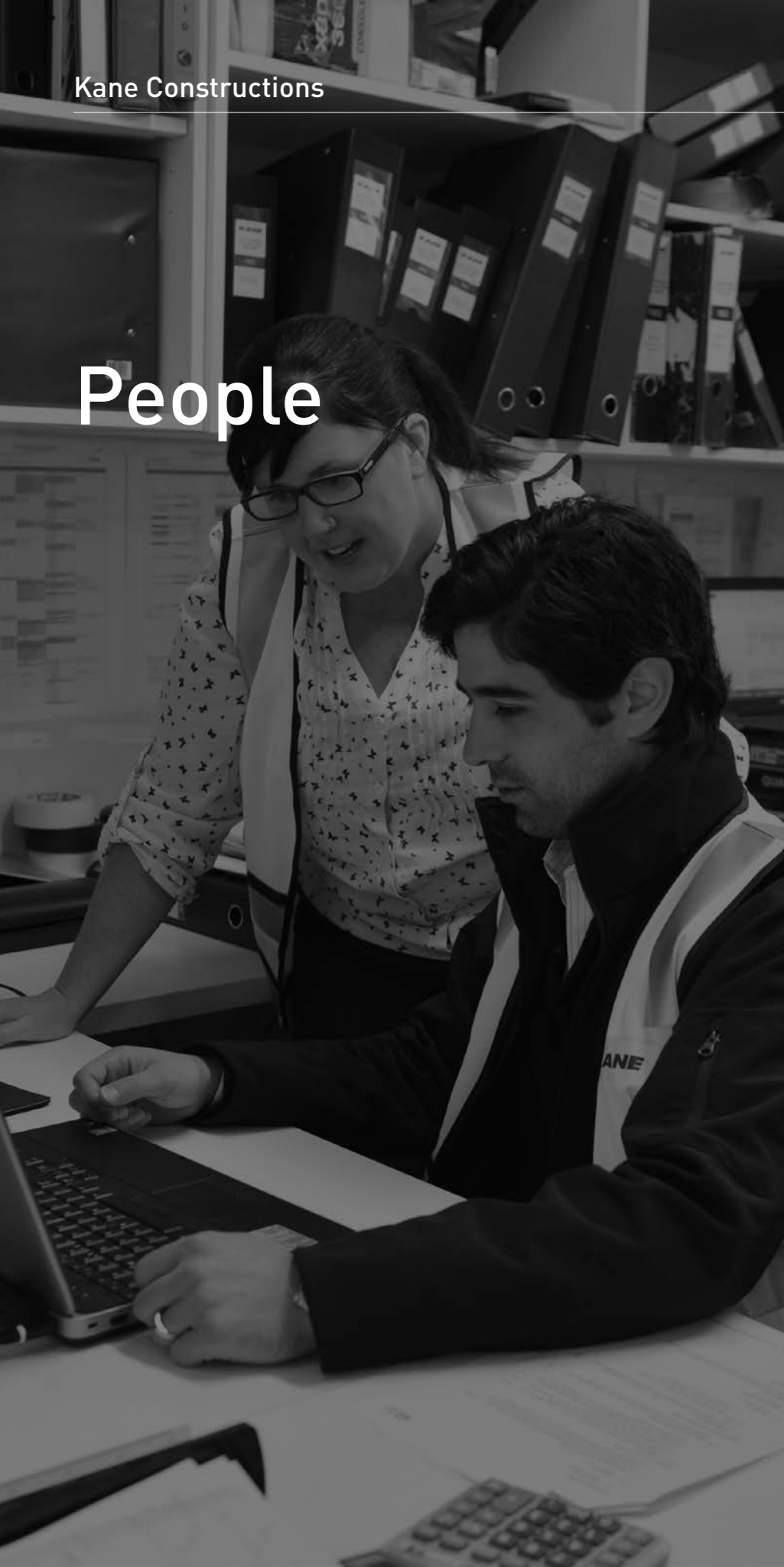

Our greatest asset is our people.

We engage and promote those with appropriate skills, experience and technical qualifications within a 'flat and open' management structure. Graduates in building, engineering and architecture occupy project management, technical management and contract administration positions.

Careful staff selection ensures Site Managers and Foreman of the highest calibre make up the on-site teams. Teamwork, backed by effective communication systems and administration resources, ensures a highly motivated approach to the most challenging projects.

Board of Directors



Jonathan Forster
Chairman



Richard Frisina
Joint Managing Director



Tristan Forster
Joint Managing Director



Julian Hamilton
Director



Tony Isaacson
Director



Geoff Purcell
Director



David Rutter
Director



Richard Sutterby
Director



Steve Theisz
Director

Organisational Structure

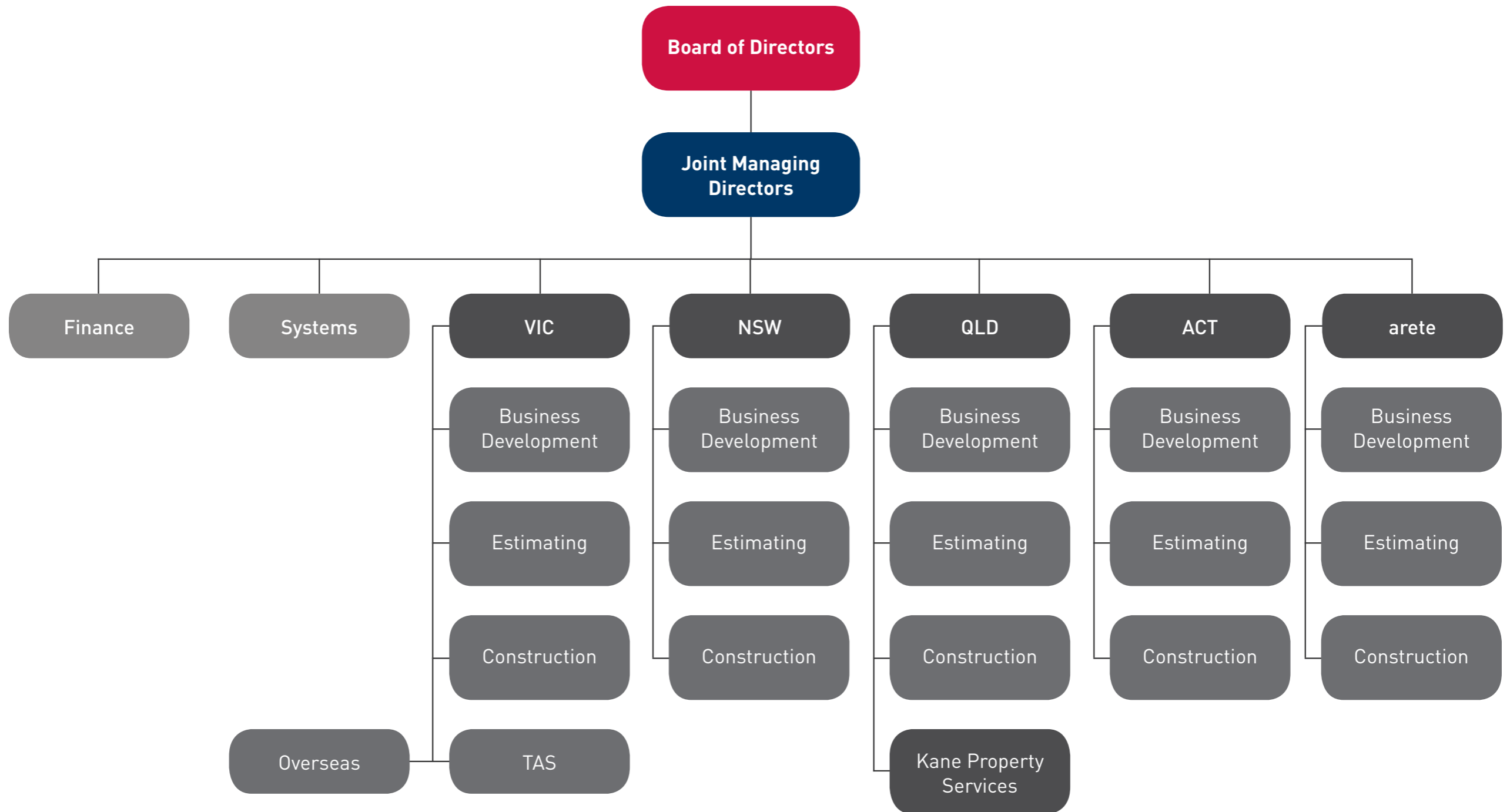

Financials

For over 40 years through the ups and downs of the building cycle, Kane Constructions has achieved steady and sustainable growth. With annual turnover in excess of \$800 million, the company is well placed to take on a mix of short, medium and longer term projects in the \$1 million to \$200 million value range.

With a strong balance sheet, no debt and significant cash reserves Kane offers its clients and their advisors financial assurance in relation to project delivery.

The construction group has total assets exceeding \$150 million with a security facility to cater for well over \$1 billion of work under construction.

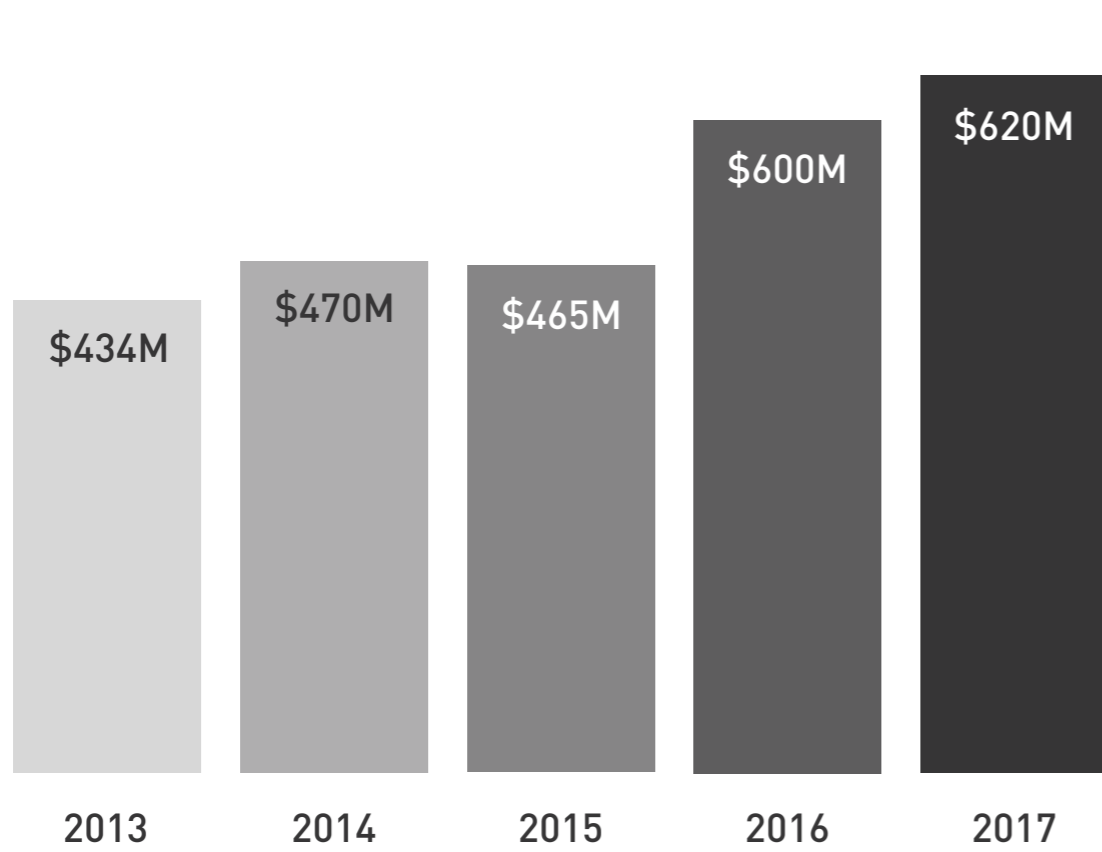

Revenue

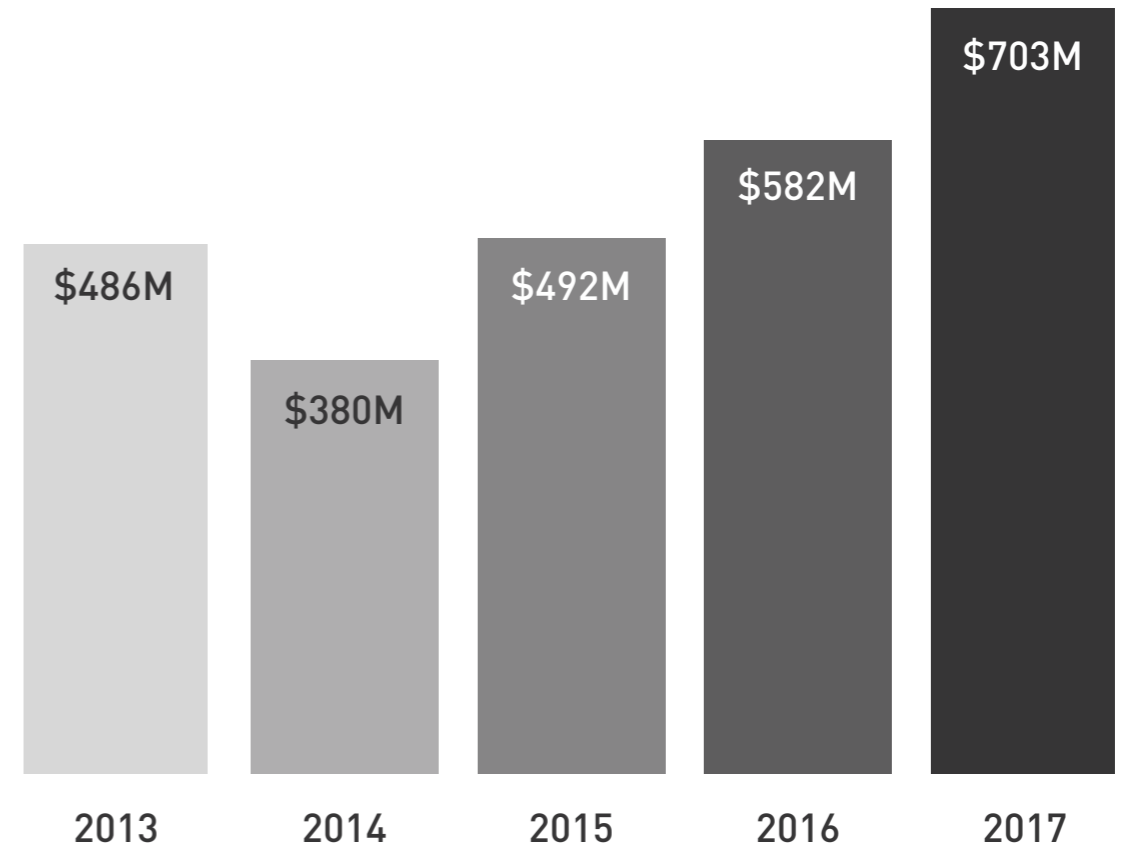

Contracts Awarded

\$815M

WORK IN HAND

44

LIVE PROJECTS

\$115M

BANK GUARANTEE /
BONDING FACILITY

\$95M

CASH ON HAND



Accreditation



Occupational Health & Safety Management System certified to AS/NZS 4801



Quality Assurance Management System certified to AS/NZS ISO 9001



Environmental Management System is certified to AS/NZS ISO 14001



Australian Government Building and Construction OHS Accreditation Scheme



National Prequalification System for Non-Residential Building for \$50 million and above

Green Star

| Project Name | State | | Client | Finish |
|---|-------|--|------------------------------------|--------|
| 01 — University of Melbourne Arts West Redevelopment | VIC | Registered for 5 Star Green Star - Education Design v1 | University of Melbourne | 2016 |
| 02 — Geelong Library & Heritage Centre | VIC | 5 Star Green Star - Public Building Design v1 | City of Greater Geelong | 2015 |
| 03 — La Trobe University Sylvia Walton Building | VIC | 5 Star Green Star - Education Design v1 | La Trobe University | 2014 |
| 04 — GE Headquarters, Springfield | QLD | 5 Star Green Star - Office Design v3 | Springfield Land Corporation | 2014 |
| 05 — Victoria University, Construction Futures | VIC | 6 Star Green Star - Education Design v1 | Victoria University | 2012 |
| 06 — La Trobe Rural Health - Health Sciences Building | VIC | 5 Star Green Star Education v1 | La Trobe University | 2012 |
| 07 — La Trobe Rural Health - Clinical Teaching Building | VIC | 5 Star Green Star Education v1 | La Trobe University | 2012 |
| 08 — MC2 Manningham City Square | VIC | 5 Star Green Star - Public Building PILOT | Manningham City Council | 2012 |
| 09 — National Centre for Synchrotron Science | VIC | 5 Star Green Star - Education Design v1 | Australian Synchrotron | 2012 |
| 10 — Kane Constructions Brisbane Office | QLD | 5 Star Green Star - Office Design v3 | Kane Constructions | 2011 |
| 11 — Dandiiri Contact Centre Photovoltaic Array | QLD | 6 Star Green Star - Office Design v2 | Project Services | 2011 |
| 12 — Swinburne University, Advanced Technology Centre | VIC | 5 Star Green Star - Education Design v1 | Swinburne University of Technology | 2011 |
| 13 — Brisbane City Hall Restoration (Stage 1) | QLD | 4 Star Green Star Public Building Design PILOT | Brisbane City Council | 2010 |
| 14 — RMIT University Building 1 | VIC | 5 Star Green Star - Office Design v2 | RMIT University | 2010 |



2016 Awards



Master Builders Australia

National Commercial Master Builder of the Year
Geelong Library and Heritage Centre, National Commercial/Industrial Construction
\$20M-\$50M

Master Builders Association of Victoria

Young Builder of the Year – David Purcell

Master Builder of the Year

Geelong Library & Heritage Centre, Excellence in Construction of Commercial Buildings
\$30M-\$80M

Epworth Richmond Lee Wing Main Works, Excellence in Construction of Commercial Buildings over \$80M

Master Builders Association of Queensland

Riverside Centre Vertical Village - Queensland Master Builders Housing & Construction Award Commercial Building up to \$5m

National Association of Women in Construction

High Commendation - Crystal Vision Award for Advancing the Interests of Women in the Construction Industry - Monica Fontaine

2016 Awards



Australian Institute of Building, National

Building Professional of the Year – David Purcell

Geelong Library & Heritage Centre, Professional Excellence Commercial Constructions
\$10M-\$50M

Australian Institute of Building, Victorian Chapter

Building Professional of the Year – David Purcell

Geelong Library & Heritage Centre, Professional Excellence Commercial Constructions
\$10M-\$50M

Aquation, High Commendation Commercial Construction \$10M-\$50M

MPavilion 2015, High Commendation Research Development & Technology

Australian Institute of Architects, Victorian Chapter

Geelong Library & Heritage Centre, The Victorian Architecture Medal

Geelong Library & Heritage Centre, The Marion Mahony Award for Interior Architecture

Geelong Library & Heritage Centre, The William Wardell Award for Public Architecture

Geelong Library & Heritage Centre, The Regional Prize

2015 Awards



Master Builders Association of Victoria

Young Builder of the Year – Tim Fowler

Owen Dixon Chambers West, Excellence in Construction of Commercial Buildings
\$20M-\$30M

Australian Institute of Architects, Victorian Chapter

MPavilion, Small Project Architecture Award - Kevin Borland Award for Small
Project Architecture

RACV Torquay Resort, Commercial Architecture Commendation

La Trobe University Sylvia Walton Building, Educational
Architecture Commendation

Master Builders Association of New South Wales

Blue Mountains Theatre & Community Hub, Excellence in Construction Awards -
Refurbishment/Renovation/Extension \$15M-\$50M

2015 Awards



Australian Institute of Architects, New South Wales Chapter

Tamarama Kiosk & Services Building, Urban Design - Lloyd Rees Award

Master Builders Association of Queensland

GE Headquarters Base Building & Integrated Fitout, Springfield, Excellence in Construction Awards - Commercial Buildings over \$5M

National Trust Queensland

Anzac Square Restoration Stage 2, Conservation Works, Gold

Queensland Rail's Roma Street Station Stage 1 Roof Restoration, Conservation Works, Gold

Government House Equitable Access, Highly Commended



Social & Community

Work hard. Play hard. Give something back.



WHERE WE OPERATE



Where We Operate

We operate throughout the east coast of Australia and overseas from offices in Melbourne, Sydney, Brisbane and Canberra.

Our head office is located in Melbourne from where we service both our metropolitan projects and our regional operations. Tasmania is also resourced from the Melbourne office.

Projects in New South Wales and the Australian Capital Territory are resourced from our Sydney and Canberra offices. Regional work is undertaken primarily along the north and south coast.

From our Brisbane office we service the Sunshine Coast and the Gold Coast. We have also delivered projects in Rockhampton and as far west as St George.

We have completed a range of International projects primarily for AusAID, Department of Foreign Affairs and Trade and Department of Defence.



- 1 Nhill
- 2 Hamilton
- 3 Horsham
- 4 Mildura
- 5 Warrnambool
- 6 Hopetoun
- 7 Ararat
- 8 Swan Hill
- 9 Ballarat
- 10 Maryborough
- 11 Torquay
- 12 Geelong
- 13 Castlemaine
- 14 Bendigo
- 15 Rochester
- 16 Queenscliff
- 17 Echuca
- 18 Portsea
- 19 Sorrento
- 20 Puckapunyal
- 21 Mornington
- 22 Cobram
- 23 Warragul
- 24 Leongatha
- 25 Moe
- 26 Tidal River
- 27 Morwell
- 28 Ararat
- 29 Wangaratta
- 30 Sale
- 31 Numerkah



Victoria

New South Wales and Australian Capital Territory



1

3

2

6

4

5



Sydney



Canberra

1

Orange

2

Wollongong

3

Menangle

4

Newcastle









5

Port Macquarie

6

Jervis Bay

 Brisbane

-  St George
-  Rockhampton
-  Toowoomba
-  Sunshine Coast
-  Gold Coast
-  Dalby
-  Mt Tamborine
-  Mitchell

Queensland

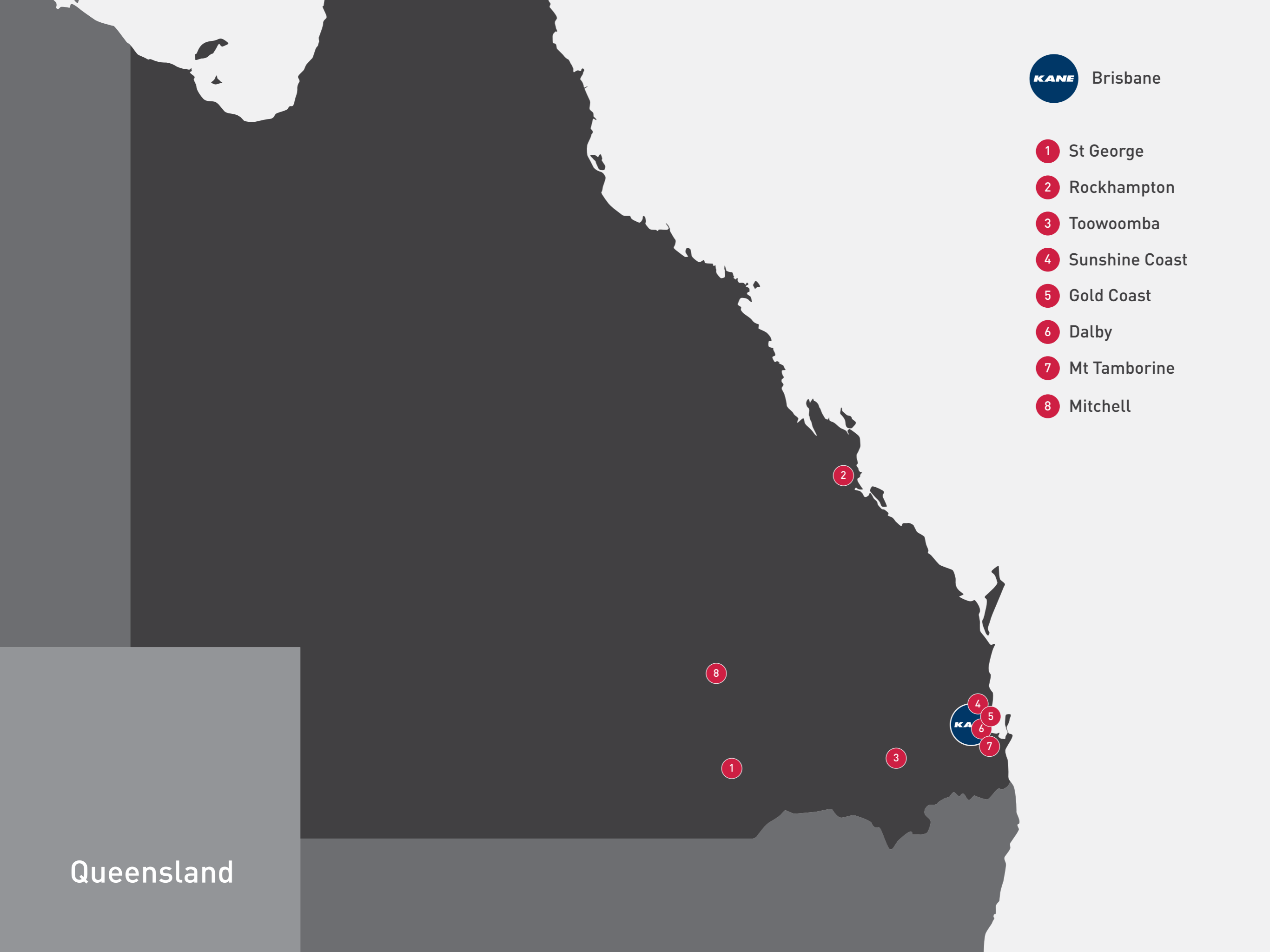

Tasmania



- 1 Launceston
- 2 Hobart
- 3 Fort Direction

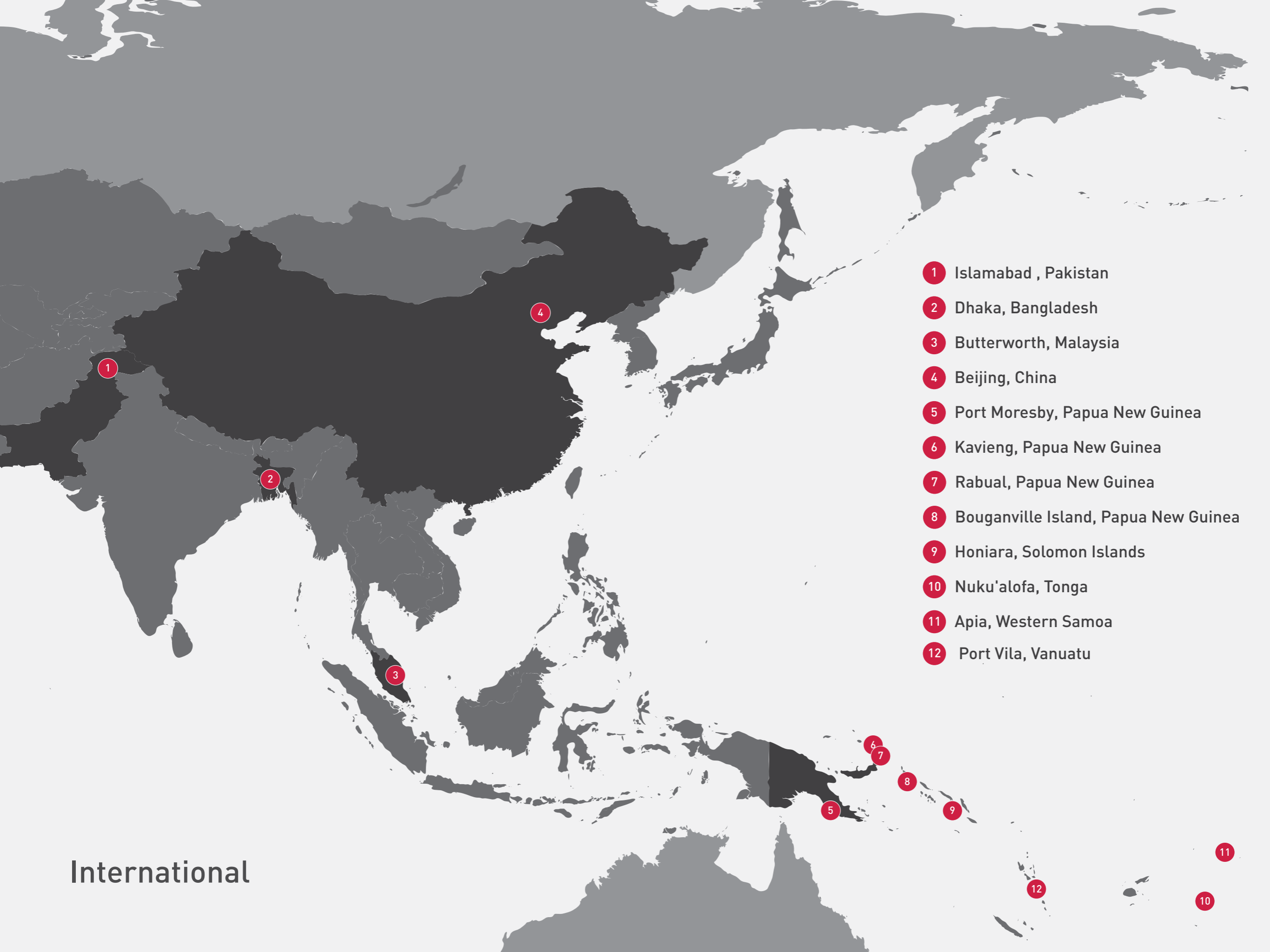

- 1 Islamabad , Pakistan
- 2 Dhaka, Bangladesh
- 3 Butterworth, Malaysia
- 4 Beijing, China
- 5 Port Moresby, Papua New Guinea
- 6 Kavieng, Papua New Guinea
- 7 Rabual, Papua New Guinea
- 8 Bouganville Island, Papua New Guinea
- 9 Honiara, Solomon Islands
- 10 Nuku'alofa, Tonga
- 11 Apia, Western Samoa
- 12 Port Vila, Vanuatu

International

PROJECTS & PEOPLE



Projects & People

The following sections provide a selection of projects delivered by Kane Constructions. Since commencing operations in 1973 we have completed over 1800 jobs across all sectors of the industry ranging in value from under \$1 million to over \$180 million.

We are proud of our work, which has been delivered in collaboration with our clients, design consultants, subcontractors and suppliers.

More importantly, our body of work could not have happened without great people.

Projects & People



Kane staff are trained and empowered to take on new challenges and fulfil their potential. Professionalism, competence, integrity and enjoying what we do are the foundations of our culture; we know our business and believe in ourselves.

In an industry where transience is common, at Kane, great value is placed on long term employment and the sharing of experience.

| | | | |
|------------------|------------|------------|------------|
| Years of service | 5+ | 10+ | 20+ |
| Number of people | 129 | 62 | 22 |
| Percentage | 51% | 25% | 9% |

Work by Sector

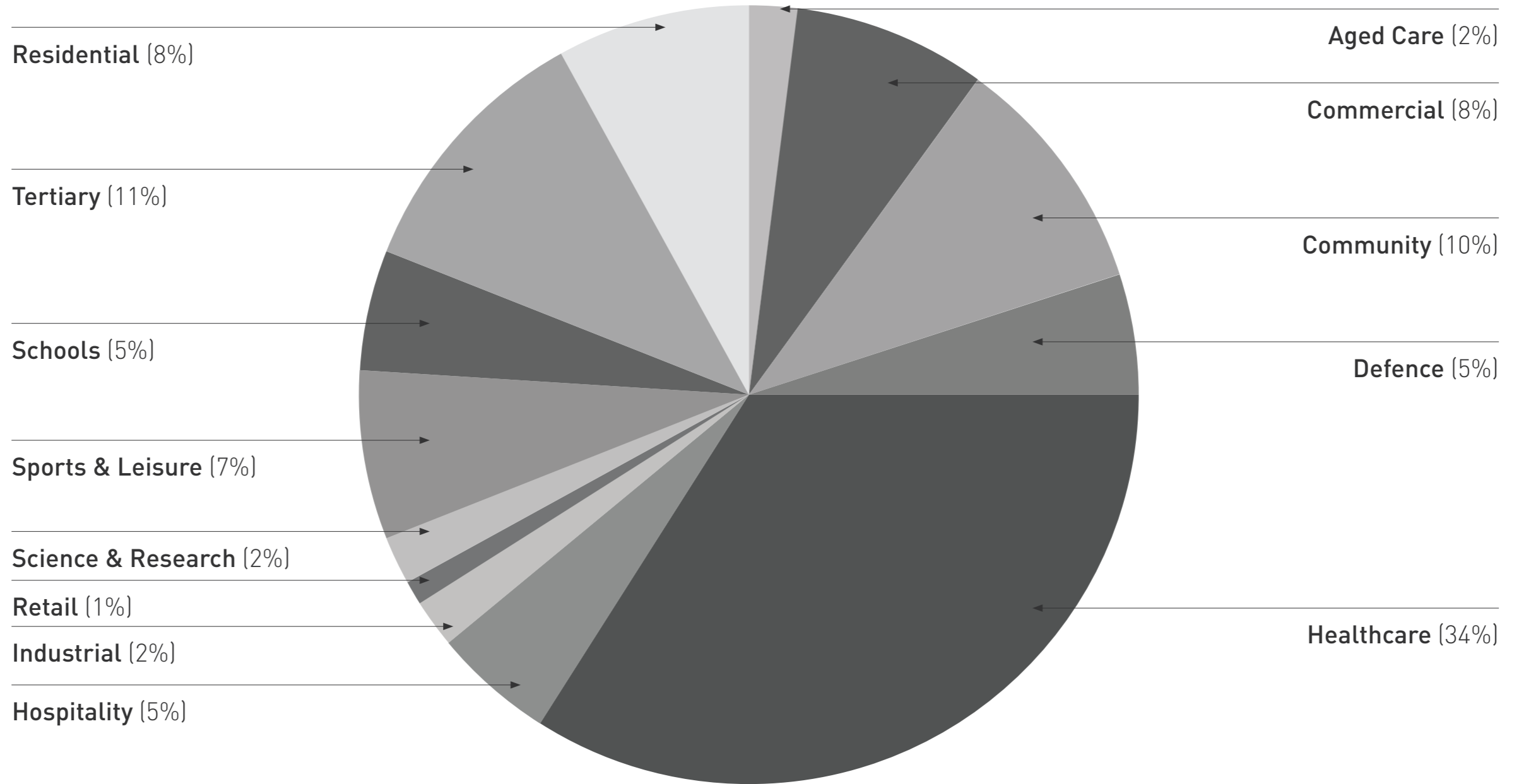

Timeline

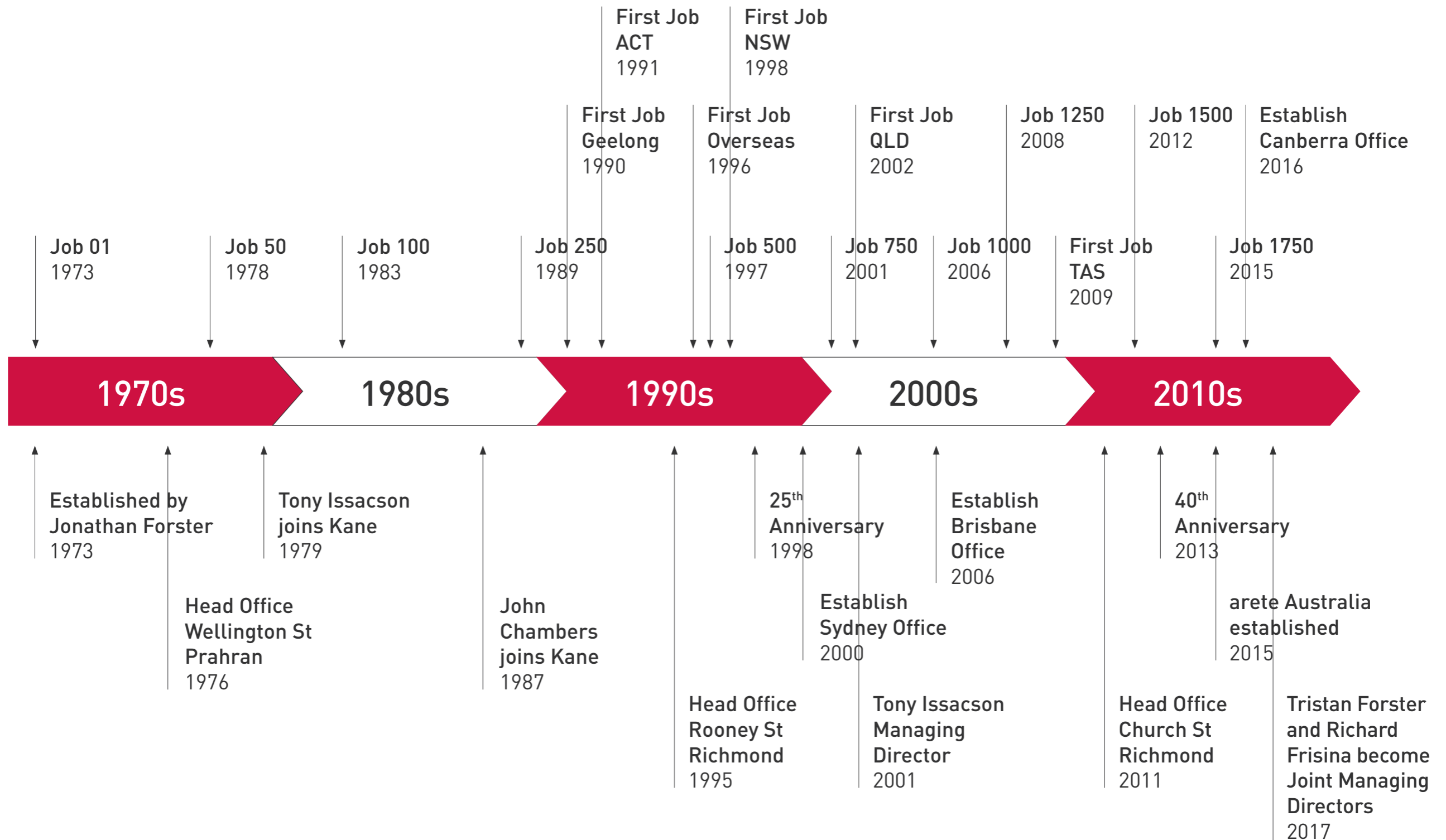

PROJECTS



HEALTH

Job Number: 1949 / 2017

Name: New Clinical Building

Client: Cabrini Health Australia

Team: Aurecon / Bates Smart / DesignInc

Location: Victoria

Value: \$75m





HEALTH

Job Number: 1867 / 2016

Name: Angliss Hospital Critical Care and Short Stay Unit Expansion Project

Client: Eastern Health

Team: Johnstaff Projects / Silver Thomas Hanley

Location: Victoria

Value: \$14m

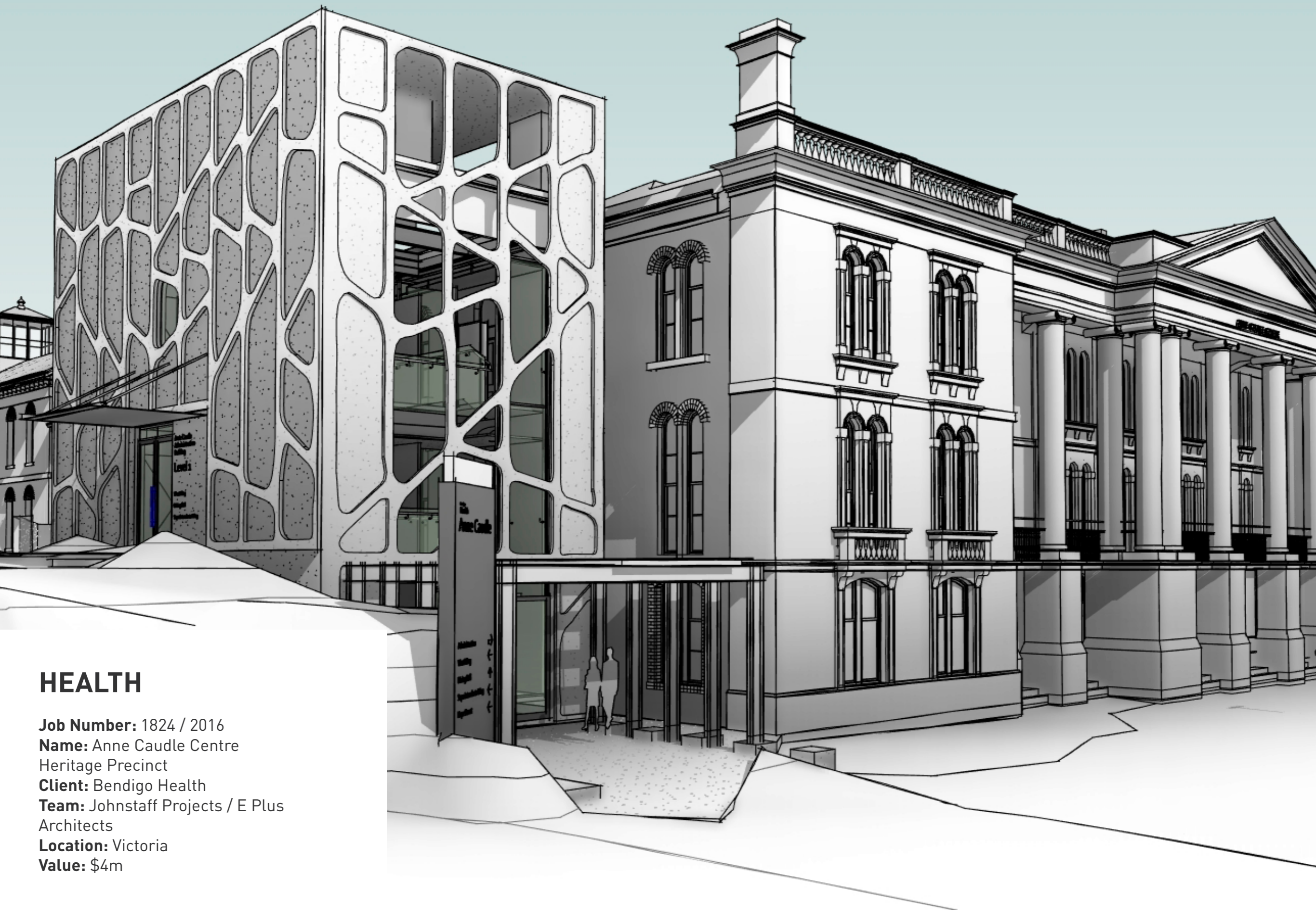

HEALTH

Job Number: 1824 / 2016

Name: Anne Caudle Centre
Heritage Precinct

Client: Bendigo Health

Team: Johnstaff Projects / E Plus
Architects

Location: Victoria

Value: \$4m



HEALTH

Job Number: 1819 / 2016

Name: Greenslopes Private Hospital
Operating Theatre 18

Client: Ramsay Health Care Limited

Team: Phillips Smith Conwell Architects
and Akalan

Location: Queensland

Value: \$1m



HEALTH

Job Number: 1812 / 2016

Name: Corrimal Medical Centre

Client: Primary Health Care

Team: Shellshear Young / Cardno

Location: New South Wales

Value: \$6m

HEALTH

Job Number: 1741 / 2017

Name: Sydney Ambulance Metropolitan
Infrastructure Strategy

Client: Department of Health Infrastructure

Team: Savills / Architectus

Location: New South Wales

Value: \$30m



HEALTH

Job Number: 1728 / 2016

Name: Bendigo Hospital Redevelopment

Client: St John of God Health Care

Team: Johnstaff Projects /
Clarke Hopkins Clarke

Location: Victoria

Value: \$30m





HEALTH

Job Number: 1723 / 2016

Name: Austin Hospital Short Stay Unit

Client: Austin Health

Team: Johnstaff Projects / Billard Leece
Partnership

Location: Victoria

Value: \$12m



HEALTH

Job Number: 1717 / 2015

Name: Greenslopes Private Hospital
Suspended Carpark

Client: Ramsay Health Care Limited

Team: Phillips Smith Conwell Architects

Location: Queensland

Value: \$3m



HEALTH

Job Number: 1705 / 2015

Name: Wyndham Clinic Stage 2
Redevelopment

Client: Techne Group

Team: Johnstaff Projects / Baade Harbour

Location: Victoria

Value: \$9m

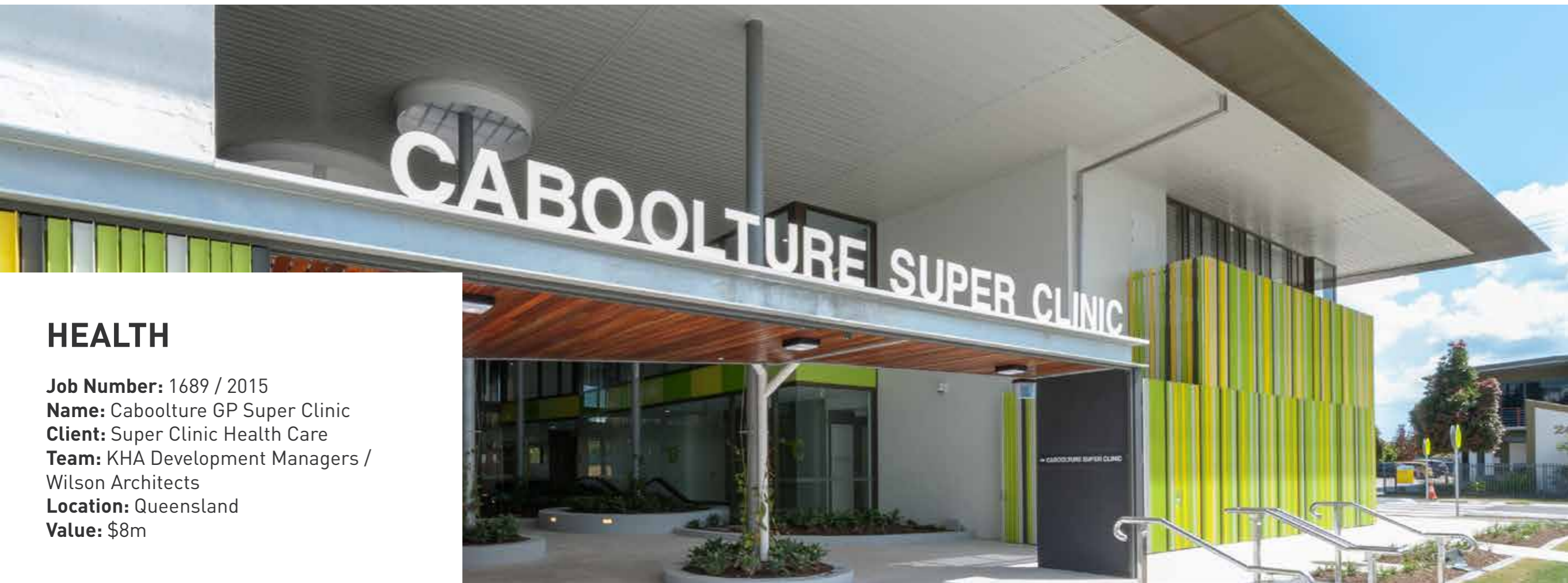

HEALTH

Job Number: 1689 / 2015

Name: Caboolture GP Super Clinic

Client: Super Clinic Health Care

Team: KHA Development Managers /
Wilson Architects

Location: Queensland

Value: \$8m



HEALTH

Job Number: 1672 / 2014

Name: Princess Alexandra Hospital
Transit Lounge

Client: Queensland Health

Team: Johnstaff Projects, Destravis,
Conrad Gargett

Location: Queensland

Value: \$3m

HEALTH

Job Number: 1663 / 2016

Name: Richmond Lee Wing Main Works

Client: Epworth Healthcare

Team: Johnstaff Projects /
Silver Thomas Hanley

Location: Victoria

Value: \$120m



HEALTH

Job Number: 1655 / 2015

Name: Numurkah Hospital Redevelopment

Client: Numurkah District Health Centre

Team: Montlaur Project Services /
Group GSA

Location: Victoria

Value: \$15m



HEALTH

Job Number: 1643 / 2014

Name: Hume GP Super Clinic

Client: Dianella Community Health

Team: Billard Leece Partnership

Location: Victoria

Value: \$7m





HEALTH

Job Number: 1632 / 2014

Name: Charlton Hospital

Client: East Wimmera Health Service

Team: Aurecon / Baade Harbour

Location: Victoria

Value: \$14m

Charlton Hospital

In 2011 the town of Charlton located in north-west Victoria was devastated by floods. The Charlton Hospital incurred major damage. Kane Constructions donated services in the form of a project team to manage the emergency rectification works. In 2012 the Victorian Government provided \$23 million of funding for a new hospital and in mid-2013 construction commenced.





HEALTH

Job Number: 1629 / 2013

Name: Richmond Lee Wing Early Works

Client: Epworth Healthcare

Team: Johnstaff Projects /
Silver Thomas Hanley

Location: Victoria

Value: \$10m

HEALTH

Job Number: 1628 / 2014

Name: Sunshine Coast GP Super Clinic

Client: Ochre Health

Team: KHA Development Managers /
Core Architecture

Location: Queensland

Value: \$7m



HEALTH

Job Number: 1617 / 2014

Name: Casey Hospital Sub-Acute

Client: Monash Health

Team: Plenary Group /
Billard Leece Partnership

Location: Victoria

Value: \$22m





HEALTH

Job Number: 1615 / 2014

Name: Blacktown Mt Druitt Hospital
Rehabilitation Unit

Client: Department of Health
Infrastructure

Team: Appian Group / SKM-S2F

Location: New South Wales

Value: \$12m



HEALTH

Job Number: 1598 / 2014

Name: Northern Hospital Emergency
Department & Special Care Nursery

Client: Northern Health

Team: Aurecon / Billard Leece
Partnership

Location: Victoria

Value: \$15m

HEALTH

Job Number: 1596 / 2014

Name: SJOG Geelong Hospital
Redevelopment

Client: St John of God

Team: Johnstaff Projects /
Silver Thomas Hanley

Location: Victoria

Value: \$50m





HEALTH

Job Number: 1588 / 2013

Name: Epworth Richmond Clinical
Education & Day Oncology

Client: Epworth Healthcare

Team: Johnstaff Projects / Silver
Thomas Hanley

Location: Victoria

Value: \$12m



HEALTH

Job Number: 1580 / 2013

Name: Westmead Hospital
Emergency Department

Client: Western Sydney
Local Health District

Team: Coffey Projects / DWP Suters

Location: New South Wales

Value: \$4m



HEALTH

Job Number: 1575 / 2013

Name: Leongatha Hospital
Redevelopment

Client: Gippsland Southern Health

Team: Davis Langdon / Vincent
Chrisp Architects

Location: Victoria

Value: \$30m



HEALTH

Job Number: 1551 / 2012

Name: Sunnybank Private Hospital

Client: Healthscope

Team: RCP / ThomsonAdsett

Location: Queensland

Value: \$2m



HEALTH

Job Number: 1545 / 2012
Name: Geelong Hospital Children's Ward
Client: Barwon Health
Team: Latitude Architects
Location: Victoria
Value: \$5m





HEALTH

Job Number: 1510 / 2014

Name: University Hospital Geelong
Major Upgrade Works

Client: Barwon Health

Team: Johnstaff Projects /
Silver Thomas Hanley

Location: Victoria

Value: \$128m

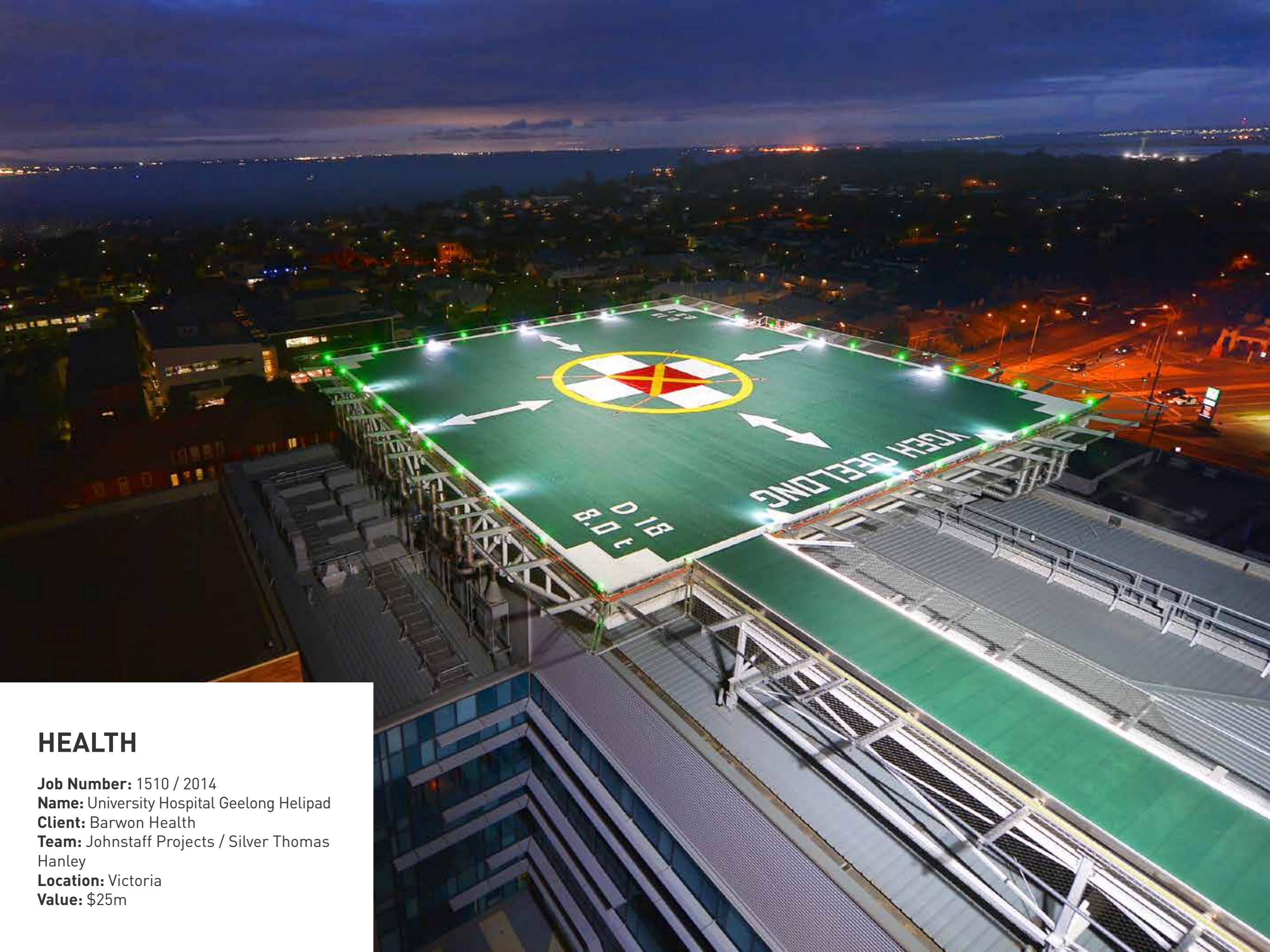

HEALTH

Job Number: 1510 / 2014

Name: University Hospital Geelong Helipad

Client: Barwon Health

Team: Johnstaff Projects / Silver Thomas
Hanley

Location: Victoria

Value: \$25m

University Hospital Geelong

In 1991 Kane Constructions was awarded the contract to deliver the Andrew Love Cancer Centre at University Hospital Geelong, a major facility providing much needed radiotherapy services to the residents of Geelong and the region. In 1997 we returned to construct the Bellarine Centre (formerly known as Dax House). Since 2004 we have had a continuous presence on campus delivering over \$175 million of major infrastructure upgrades and capital works projects. Our team has recently completed the \$128 million University Hospital Geelong Major Upgrade Works.



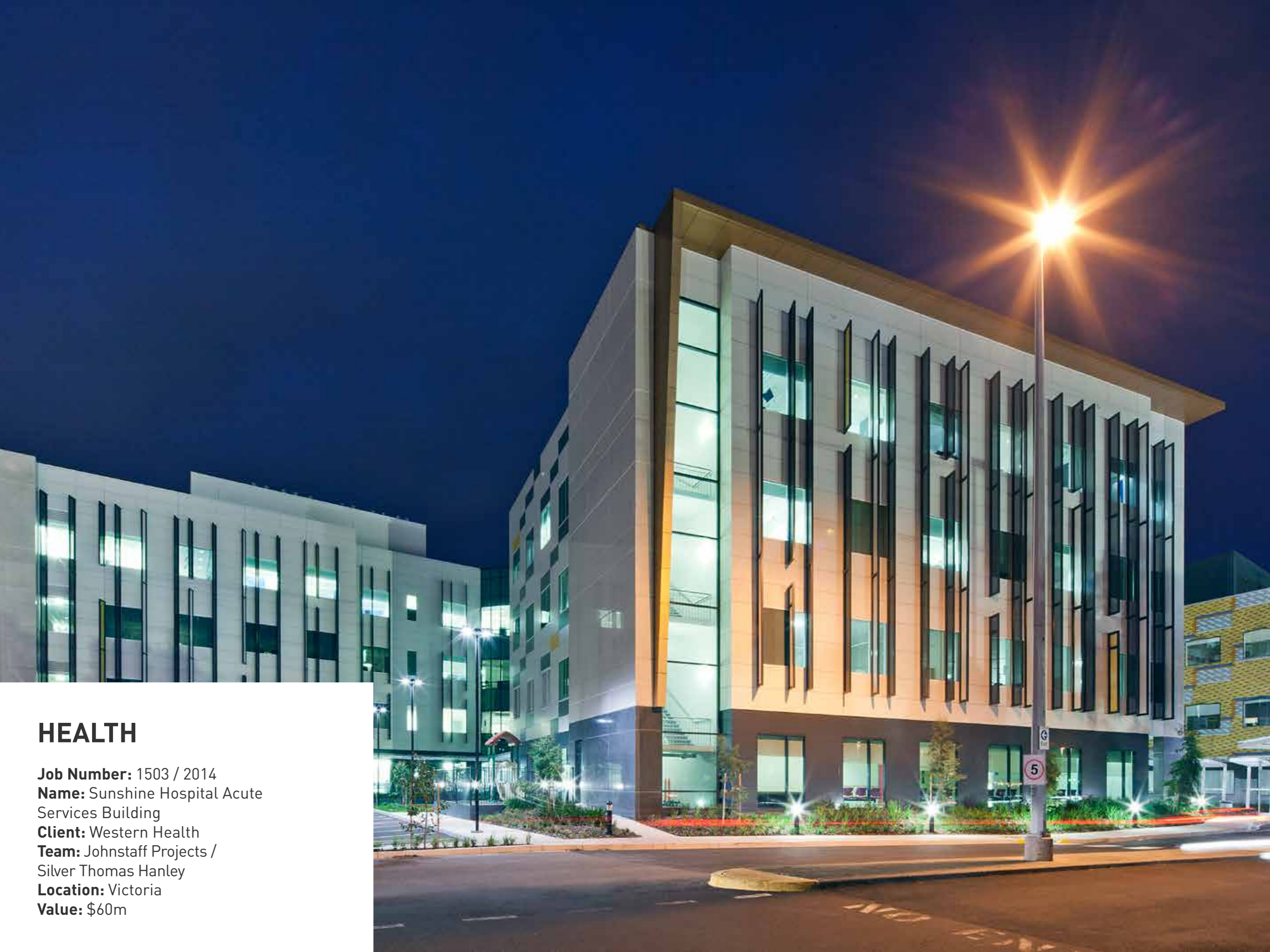

HEALTH

Job Number: 1503 / 2014

Name: Sunshine Hospital Acute
Services Building

Client: Western Health

Team: Johnstaff Projects /
Silver Thomas Hanley

Location: Victoria

Value: \$60m



HEALTH

Job Number: 1460 / 2011

Name: North Richmond Community Health Centre

Client: Department of Health

Team: Aurecon / Lyons

Location: Victoria

Value: \$16m



HEALTH

Job Number: 1431 / 2013

Name: Dandenong Hospital
Mental Health

Client: Monash Health

Team: Coffey Projects / Bates Smart

Location: Victoria

Value: \$69m



HEALTH

Job Number: 1405 / 2010

Name: Kardinia Health Super Clinic

Client: Barwon Health

Team: Aurecon / Billard Leece Partnership

Location: Victoria

Value: \$7m





HEALTH

Job Number: 1397 / 2010

Name: Austin Health &
Rehabilitation Centre

Client: Austin Health

Team: Aurecon / Silver Thomas Hanley

Location: Victoria

Value: \$12m





HEALTH

Job Number: 1392 / 2010

Name: Knox Private Hospital IPU

Client: Healthscope

Team: Johnstaff Projects / Billard
Leece Partnership

Location: Victoria

Value: \$25m

HEALTH

Job Number: 1391 / 2011

Name: Dandenong Hospital
Emergency Department

Client: Monash Health

Team: Coffey Projects / Bates Smart

Location: Victoria

Value: \$25m





HEALTH

Job Number: 1390 / 2010

Name: Cancer Centre

Client: St Vincent's Hospital

Team: Charter Keck Cramer / Hassell

Location: Victoria

Value: \$12m

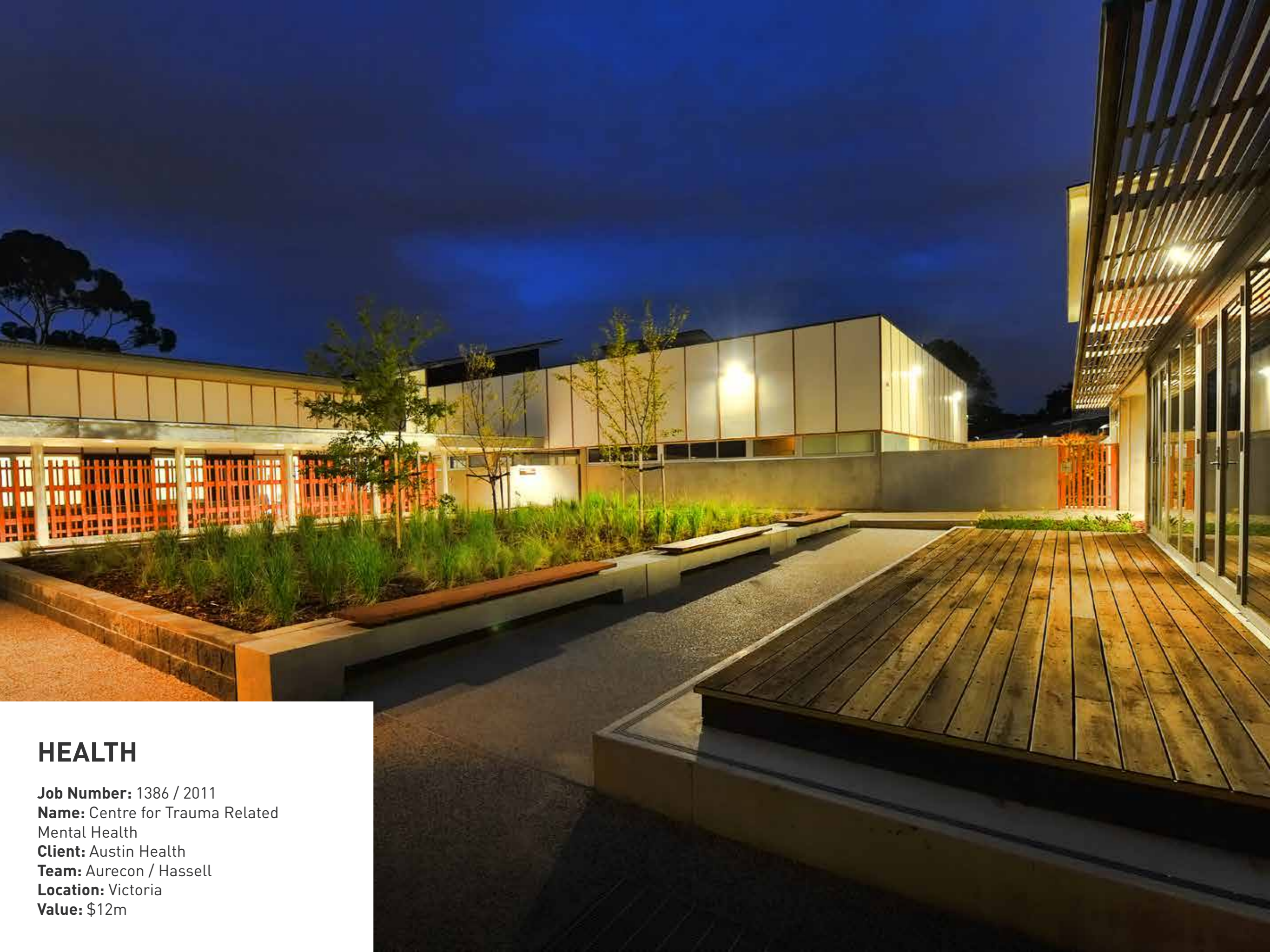

HEALTH

Job Number: 1386 / 2011

Name: Centre for Trauma Related
Mental Health

Client: Austin Health

Team: Aurecon / Hassell

Location: Victoria

Value: \$12m

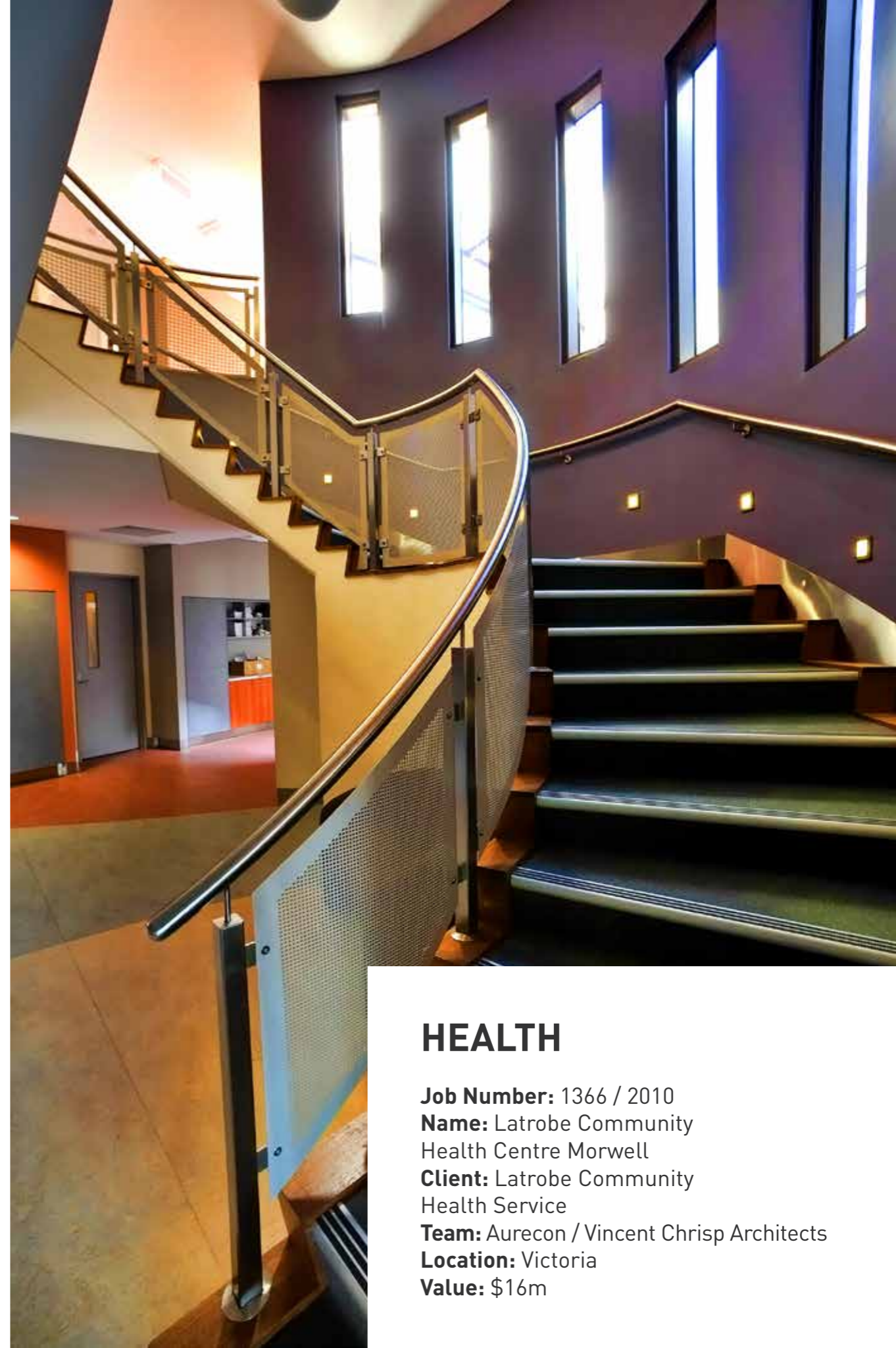

HEALTH

Job Number: 1366 / 2010

Name: Latrobe Community
Health Centre Morwell

Client: Latrobe Community
Health Service

Team: Aurecon / Vincent Crisp Architects

Location: Victoria

Value: \$16m

HEALTH

Job Number: 1354 / 2010

Name: Teacher Training
& Research Facility

Client: Barwon Health

Team: Aurecon / Billard Leece Partnership

Location: Victoria

Value: \$18m





HEALTH

Job Number: 1346 / 2010
Name: Caulfield Hospital
Redevelopment Stage 1&2
Client: Alfred Health
Team: Johnstaff Projects /
Silver Thomas Hanley
Location: Victoria
Value: \$40m



HEALTH

Job Number: 1342 / 2010

Name: Frankston Hospital Stage 2A

Client: Peninsula Health

Team: Johnstaff Projects / Lyons

Location: Victoria

Value: \$35m



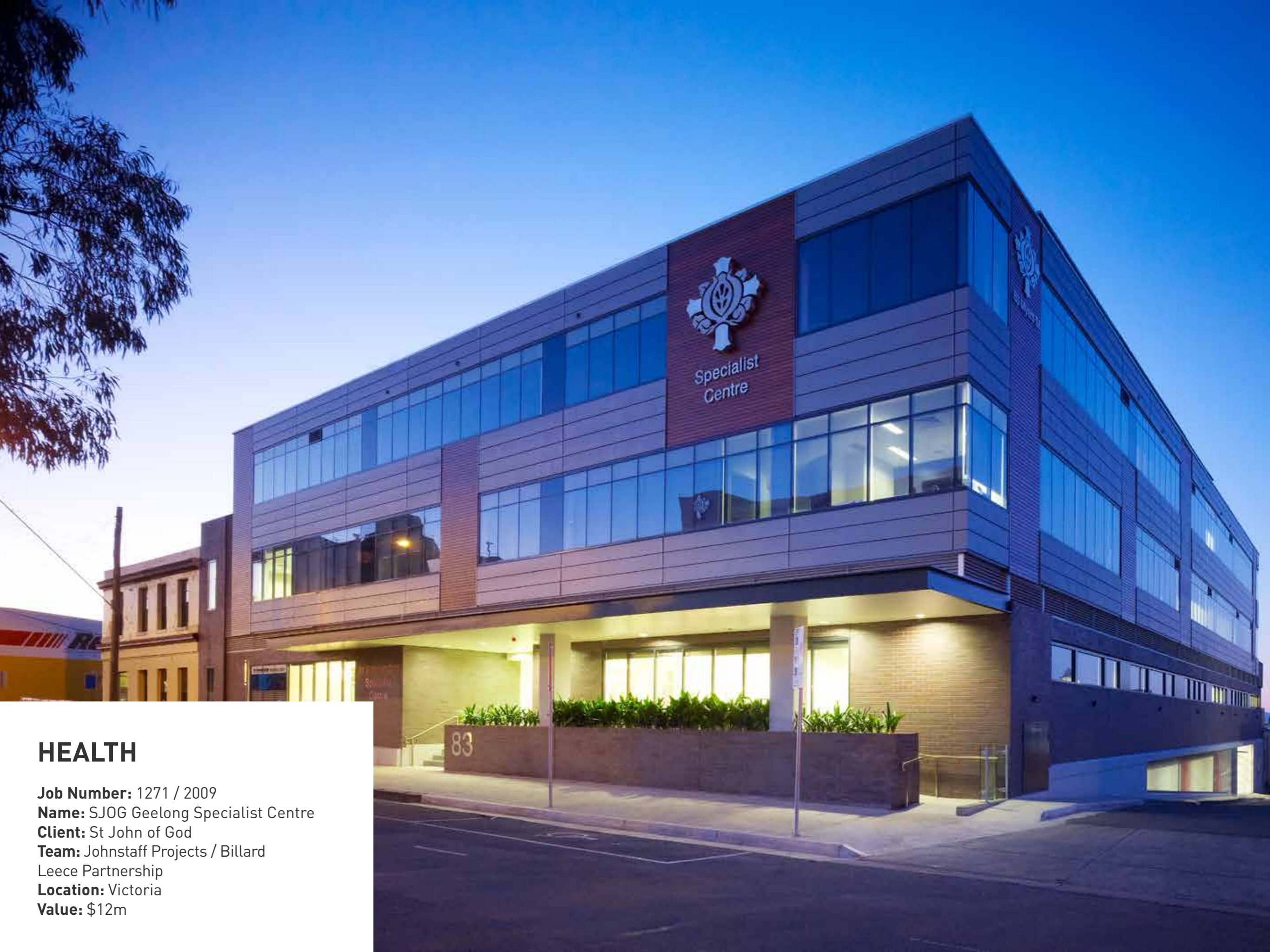

HEALTH

Job Number: 1271 / 2009

Name: SJOG Geelong Specialist Centre

Client: St John of God

Team: Johnstaff Projects / Billard

Leece Partnership

Location: Victoria

Value: \$12m



HEALTH

Job Number: 1230 / 2009

Name: University Hospital Geelong

Client: Barwon Health

Team: Aurecon / Silver Thomas Hanley

Location: Victoria

Value: \$25m



HEALTH

Job Number: 1212 / 2008

Name: Jade House

Client: Karitane

Team: DWP Suters

Location: New South Wales

Value: \$4m

Primary Health Care Ltd

Since 2005 Kane Constructions has teamed with Shellshear Young architects to deliver ten medical centres for Primary Health Care Ltd in Victoria and Queensland. Projects have included both fitout and new build ranging in value from \$1 million to \$6 million.

| | |
|----------|---------------------------------------|
| Job 1052 | Melton Medical Centre, VIC |
| Job 1126 | Eureka Medical and Dental Centre, VIC |
| Job 1186 | Oxley Medical & Dental Centre, QLD |
| Job 1281 | Frankston Medical Centre, VIC |
| Job 1248 | Morayfield Medical Centre, QLD |
| Job 1295 | Hihett Medical and Dental Centre, VIC |
| Job 1312 | Murrumba Downs Medical Centre, QLD |
| Job 1368 | Springfield Medical Centre, QLD |
| Job 1408 | Ipswich Medical Centre, QLD |
| Job 1542 | Caboolture Medical Centre, QLD |
| Job 1812 | Corrimal Medical Centre, NSW |





HEALTH

Job Number: 1168 / 2007

Name: Wantirna Health

Client: Eastern Health

Team: Aurecon / Tectura

Location: Victoria

Value: \$23m

HEALTH

Job Number: 1093 / 2006

Name: Austin Mental Health Facility

Client: Austin Health

Team: Aurecon /
Health Science Planning Consultants

Location: Victoria

Value: \$15m



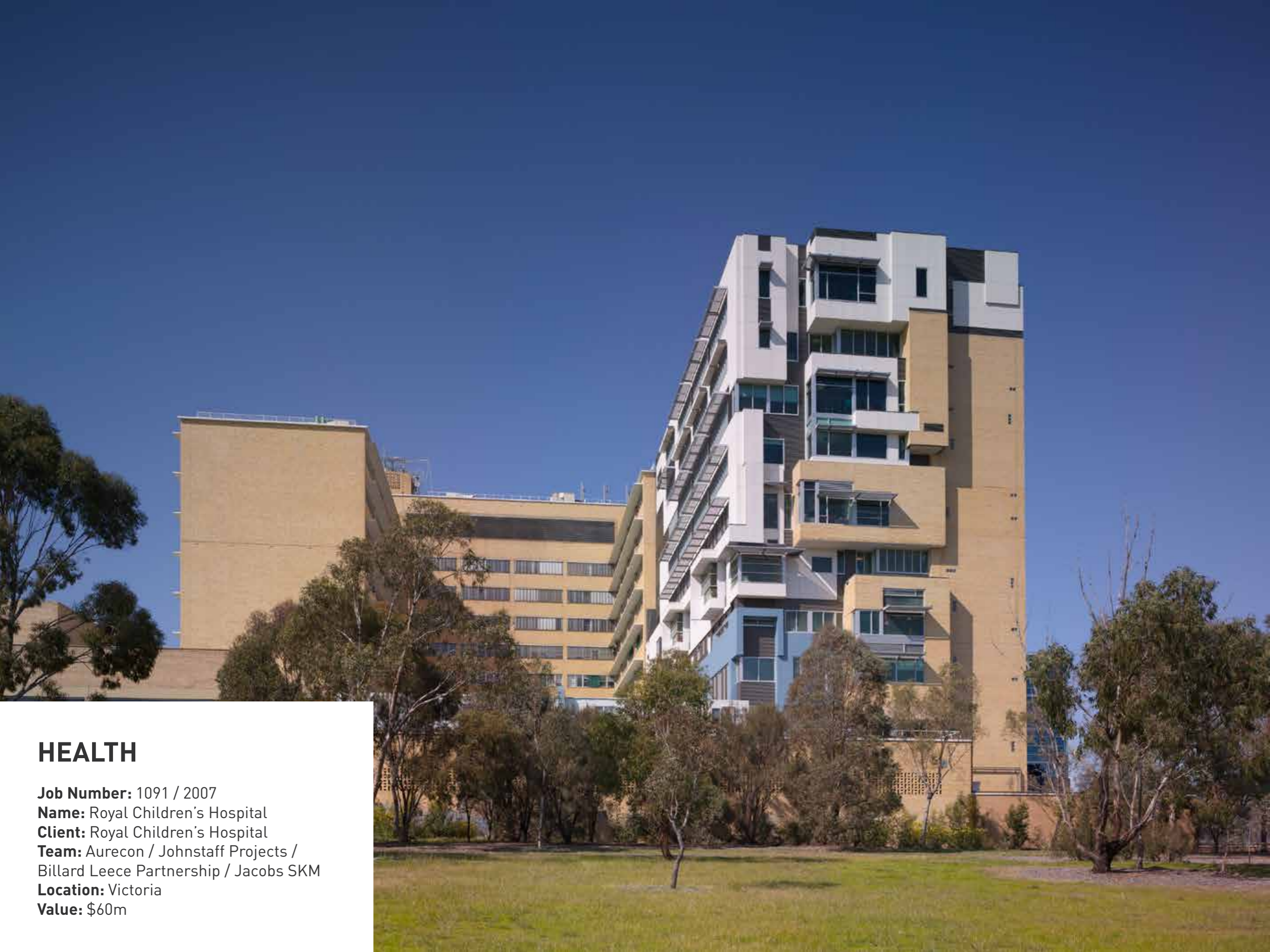

HEALTH

Job Number: 1091 / 2007

Name: Royal Children's Hospital

Client: Royal Children's Hospital

Team: Aurecon / Johnstaff Projects /
Billard Leece Partnership / Jacobs SKM

Location: Victoria

Value: \$60m



HEALTH

Job Number: 1025 / 2006

Name: Nhill Hospital

Client: West Wimmera Health Service

Team: Health Science
Planning Consultants

Location: Victoria

Value: \$11m



HEALTH

Job Number: 811 / 2003

Name: Kyneton Hospital

Client: Kyneton District Health Service

Team: Aurecon / Lyons

Location: Victoria

Value: \$12m





Barwon
Health
The Geelong Hospital

HEALTH

Job Number: 544 / 1996

Name: Geelong Hospital Bellerine Centre

Client: Barwon Health

Team: Aurecon / Lyons

Location: Victoria

Value: \$18m

Kane Constructions

kane.com.au

VICTORIA

Jonathan Angelopoulos

0430 369 499

jange@kane.com.au

NEW SOUTH WALES

Dominic Begley

0434 735 033

dbegley@kane.com.au

QUEENSLAND

Lauri Brown

0447 231 838

lbrown@kane.com.au

AUSTRALIAN CAPITAL TERRITORY

Jon Anastasov

0468 988 207

janastasov@kane.com.au