

***KANE***

**SECTOR:  
RETAIL &  
HOSPITALITY**



# ABOUT US





# Who We Are

We are a privately owned commercial construction company active in all sectors of the industry. With a turnover in excess of \$800 million and over 400 full time employees, we operate throughout the east coast of Australia and overseas from offices in Melbourne, Sydney, Brisbane and Canberra.

**‘Our success is recognised in the way we achieve, as much as what we achieve.’**



# People

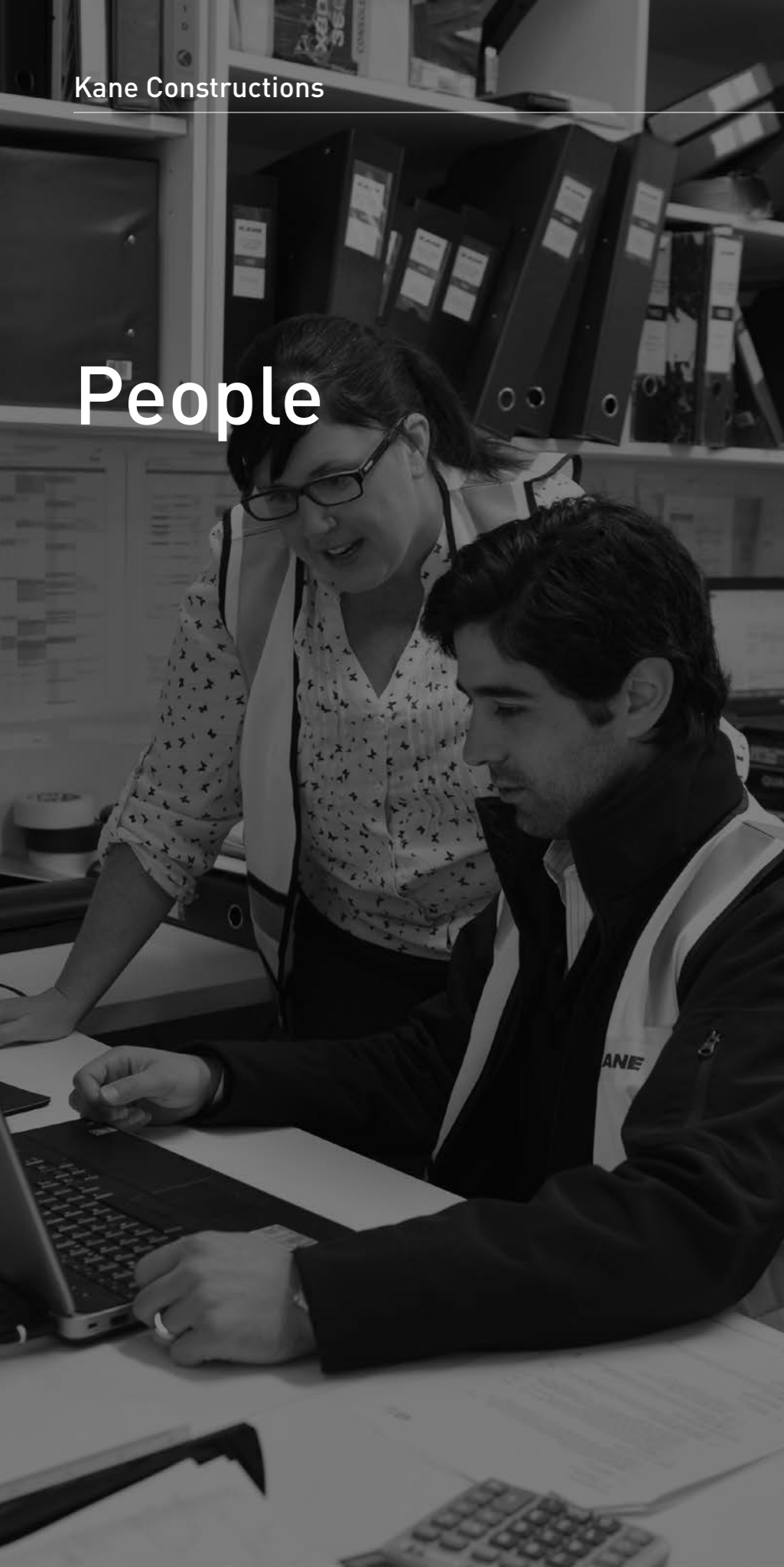

Our greatest asset is our people.

We engage and promote those with appropriate skills, experience and technical qualifications within a 'flat and open' management structure. Graduates in building, engineering and architecture occupy project management, technical management and contract administration positions.

Careful staff selection ensures Site Managers and Foreman of the highest calibre make up the on-site teams. Teamwork, backed by effective communication systems and administration resources, ensures a highly motivated approach to the most challenging projects.



# Board of Directors



**Jonathan Forster**  
Chairman



**Richard Frisina**  
Joint Managing Director



**Tristan Forster**  
Joint Managing Director



**Julian Hamilton**  
Director



**Tony Isaacson**  
Director



**Geoff Purcell**  
Director



**David Rutter**  
Director



**Richard Sutterby**  
Director



**Steve Theisz**  
Director

# Organisational Structure

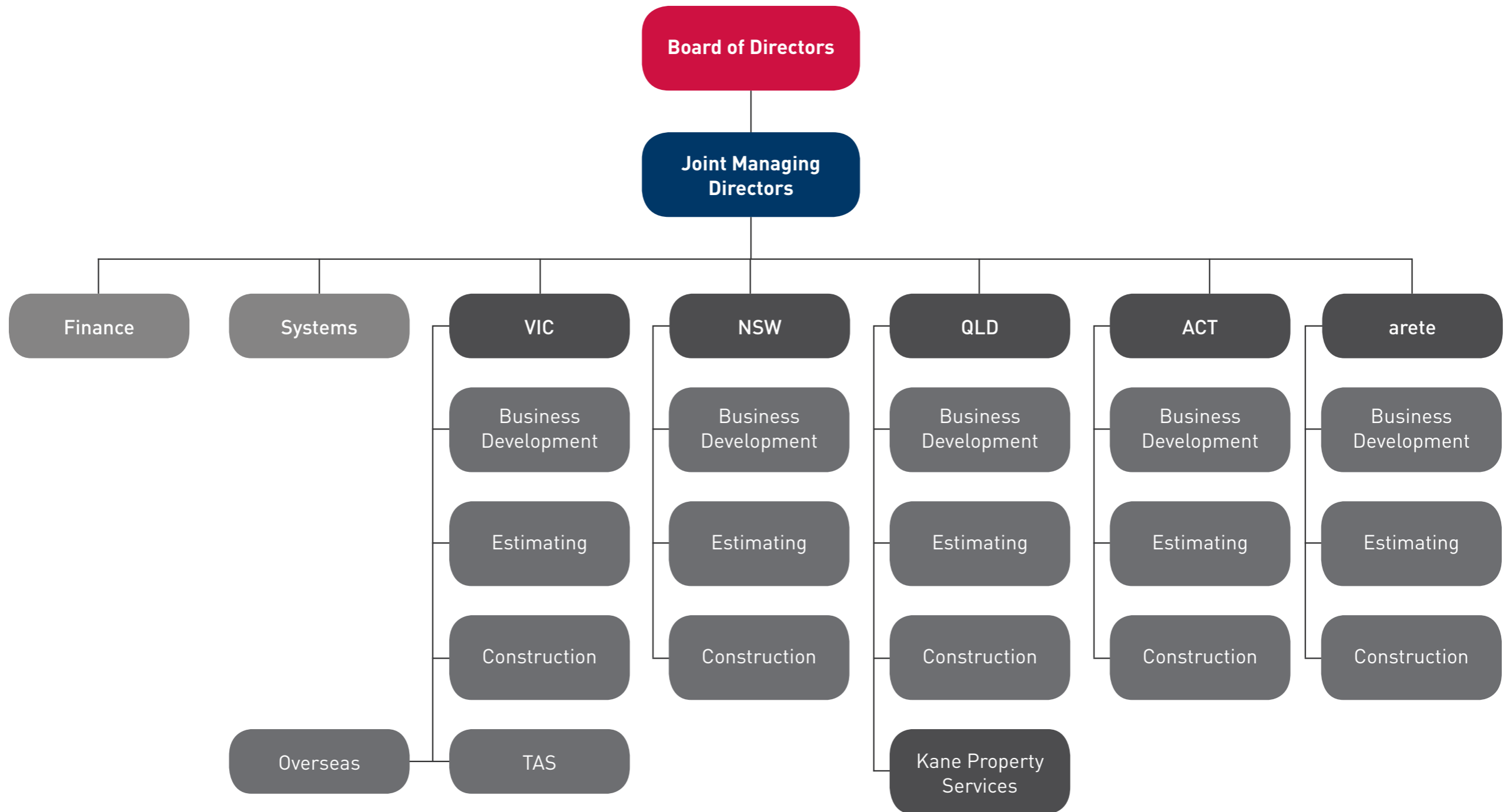



# Financials

For over 40 years through the ups and downs of the building cycle, Kane Constructions has achieved steady and sustainable growth. With annual turnover in excess of \$800 million, the company is well placed to take on a mix of short, medium and longer term projects in the \$1 million to \$200 million value range.

With a strong balance sheet, no debt and significant cash reserves Kane offers its clients and their advisors financial assurance in relation to project delivery.

The construction group has total assets exceeding \$150 million with a security facility to cater for well over \$1 billion of work under construction.

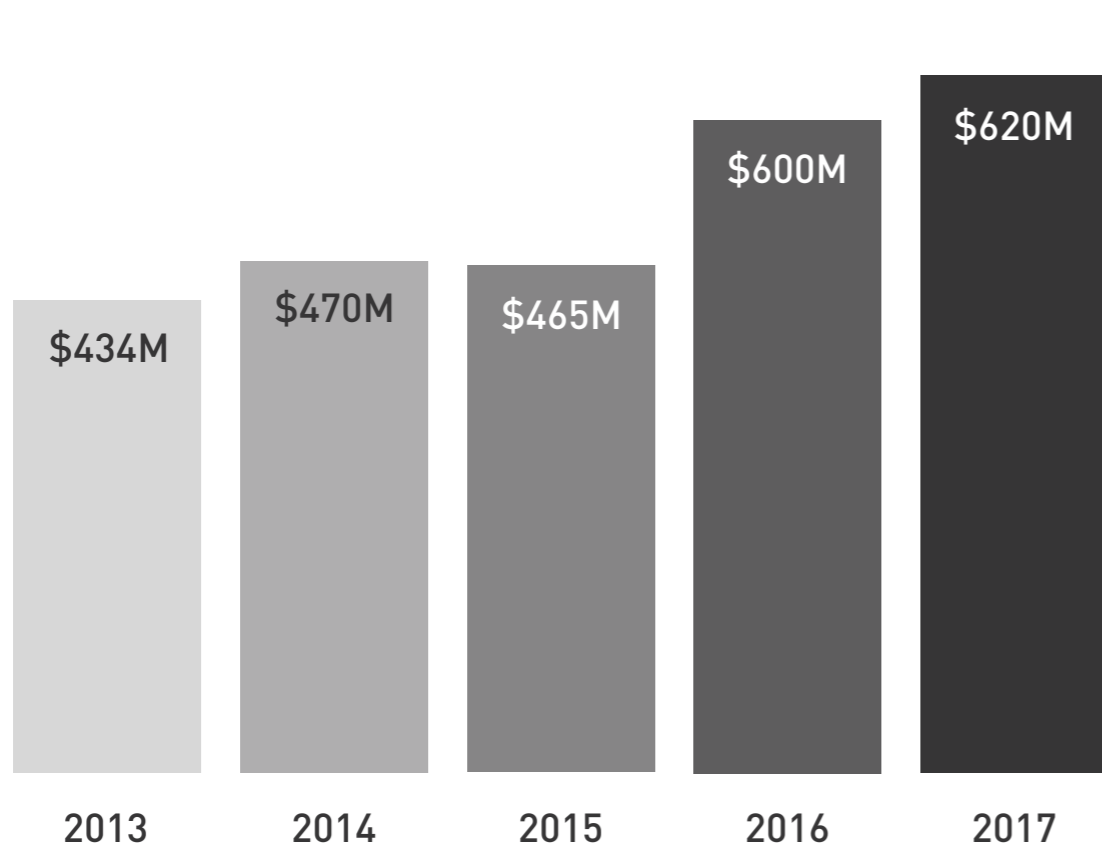

Revenue

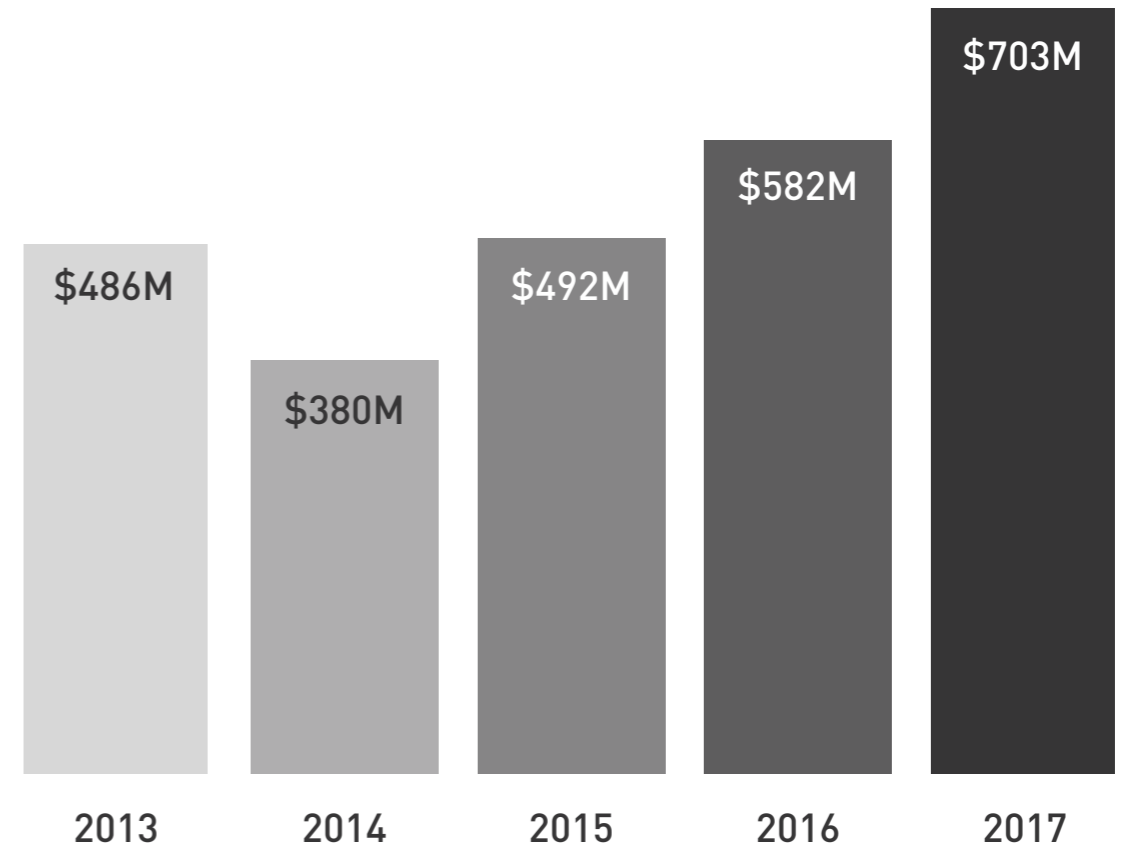

Contracts Awarded

**\$815M**

WORK IN HAND

**44**

LIVE PROJECTS

**\$115M**

BANK GUARANTEE /  
BONDING FACILITY

**\$95M**

CASH ON HAND





# Accreditation



Occupational Health & Safety Management System certified to AS/NZS 4801



Quality Assurance Management System certified to AS/NZS ISO 9001



Environmental Management System is certified to AS/NZS ISO 14001



Australian Government Building and Construction OHS Accreditation Scheme



National Prequalification System for Non-Residential Building for \$50 million and above

# Green Star

| Project Name  | State |  | Client                             | Finish |
|---|-------|--|------------------------------------|--------|
| 01 — University of Melbourne Arts West Redevelopment    | VIC   | Registered for 5 Star Green Star - Education Design v1 | University of Melbourne            | 2016   |
| 02 — Geelong Library & Heritage Centre                  | VIC   | 5 Star Green Star - Public Building Design v1          | City of Greater Geelong            | 2015   |
| 03 — La Trobe University Sylvia Walton Building         | VIC   | 5 Star Green Star - Education Design v1                | La Trobe University                | 2014   |
| 04 — GE Headquarters, Springfield                       | QLD   | 5 Star Green Star - Office Design v3                   | Springfield Land Corporation       | 2014   |
| 05 — Victoria University, Construction Futures          | VIC   | 6 Star Green Star - Education Design v1                | Victoria University                | 2012   |
| 06 — La Trobe Rural Health - Health Sciences Building   | VIC   | 5 Star Green Star Education v1                         | La Trobe University                | 2012   |
| 07 — La Trobe Rural Health - Clinical Teaching Building | VIC   | 5 Star Green Star Education v1                         | La Trobe University                | 2012   |
| 08 — MC2 Manningham City Square                         | VIC   | 5 Star Green Star - Public Building PILOT              | Manningham City Council            | 2012   |
| 09 — National Centre for Synchrotron Science            | VIC   | 5 Star Green Star - Education Design v1                | Australian Synchrotron             | 2012   |
| 10 — Kane Constructions Brisbane Office                 | QLD   | 5 Star Green Star - Office Design v3                   | Kane Constructions                 | 2011   |
| 11 — Dandiiri Contact Centre Photovoltaic Array         | QLD   | 6 Star Green Star - Office Design v2                   | Project Services                   | 2011   |
| 12 — Swinburne University, Advanced Technology Centre   | VIC   | 5 Star Green Star - Education Design v1                | Swinburne University of Technology | 2011   |
| 13 — Brisbane City Hall Restoration (Stage 1)           | QLD   | 4 Star Green Star Public Building Design PILOT         | Brisbane City Council              | 2010   |
| 14 — RMIT University Building 1                         | VIC   | 5 Star Green Star - Office Design v2                   | RMIT University                    | 2010   |







# 2016 Awards



## Master Builders Australia

---

National Commercial Master Builder of the Year  
Geelong Library and Heritage Centre, National Commercial/Industrial Construction  
\$20M-\$50M

---

## Master Builders Association of Victoria

---

Young Builder of the Year – David Purcell

---

Master Builder of the Year

---

Geelong Library & Heritage Centre, Excellence in Construction of Commercial Buildings  
\$30M-\$80M

---

Epworth Richmond Lee Wing Main Works, Excellence in Construction of Commercial Buildings over \$80M

---

## Master Builders Association of Queensland

---

Riverside Centre Vertical Village - Queensland Master Builders Housing & Construction Award Commercial Building up to \$5m

---

## National Association of Women in Construction

---

High Commendation - Crystal Vision Award for Advancing the Interests of Women in the Construction Industry - Monica Fontaine

---

# 2016 Awards



## Australian Institute of Building, National

---

Building Professional of the Year – David Purcell

---

Geelong Library & Heritage Centre, Professional Excellence Commercial Constructions  
\$10M-\$50M

---

## Australian Institute of Building, Victorian Chapter

---

Building Professional of the Year – David Purcell

---

Geelong Library & Heritage Centre, Professional Excellence Commercial Constructions  
\$10M-\$50M

---

Aquation, High Commendation Commercial Construction \$10M-\$50M

---

MPavilion 2015, High Commendation Research Development & Technology

---

## Australian Institute of Architects, Victorian Chapter

---

Geelong Library & Heritage Centre, The Victorian Architecture Medal

---

Geelong Library & Heritage Centre, The Marion Mahony Award for Interior Architecture

---

Geelong Library & Heritage Centre, The William Wardell Award for Public Architecture

---

Geelong Library & Heritage Centre, The Regional Prize

---



# 2015 Awards



## Master Builders Association of Victoria

---

Young Builder of the Year – Tim Fowler

---

Owen Dixon Chambers West, Excellence in Construction of Commercial Buildings  
\$20M-\$30M

---

## Australian Institute of Architects, Victorian Chapter

---

MPavilion, Small Project Architecture Award - Kevin Borland Award for Small  
Project Architecture

---

RACV Torquay Resort, Commercial Architecture Commendation

---

La Trobe University Sylvia Walton Building, Educational  
Architecture Commendation

---

## Master Builders Association of New South Wales

---

Blue Mountains Theatre & Community Hub, Excellence in Construction Awards -  
Refurbishment/Renovation/Extension \$15M-\$50M

---



# 2015 Awards



## Australian Institute of Architects, New South Wales Chapter

---

Tamarama Kiosk & Services Building, Urban Design - Lloyd Rees Award

---

## Master Builders Association of Queensland

---

GE Headquarters Base Building & Integrated Fitout, Springfield, Excellence in Construction Awards - Commercial Buildings over \$5M

---

## National Trust Queensland

---

Anzac Square Restoration Stage 2, Conservation Works, Gold

---

Queensland Rail's Roma Street Station Stage 1 Roof Restoration, Conservation Works, Gold

---

Government House Equitable Access, Highly Commended

---





# Social & Community

Work hard. Play hard. Give something back.





# WHERE WE OPERATE



# Where We Operate

We operate throughout the east coast of Australia and overseas from offices in Melbourne, Sydney, Brisbane and Canberra.

Our head office is located in Melbourne from where we service both our metropolitan projects and our regional operations. Tasmania is also resourced from the Melbourne office.

Projects in New South Wales and the Australian Capital Territory are resourced from our Sydney and Canberra offices. Regional work is undertaken primarily along the north and south coast.

From our Brisbane office we service the Sunshine Coast and the Gold Coast. We have also delivered projects in Rockhampton and as far west as St George.

We have completed a range of International projects primarily for AusAID, Department of Foreign Affairs and Trade and Department of Defence.





- 1 Nhill
- 2 Hamilton
- 3 Horsham
- 4 Mildura
- 5 Warrnambool
- 6 Hopetoun
- 7 Ararat
- 8 Swan Hill
- 9 Ballarat
- 10 Maryborough
- 11 Torquay
- 12 Geelong
- 13 Castlemaine
- 14 Bendigo
- 15 Rochester
- 16 Queenscliff
- 17 Echuca
- 18 Portsea
- 19 Sorrento
- 20 Puckapunyal
- 21 Mornington
- 22 Cobram
- 23 Warragul
- 24 Leongatha
- 25 Moe
- 26 Tidal River
- 27 Morwell
- 28 Ararat
- 29 Wangaratta
- 30 Sale
- 31 Numerkah



Victoria

# New South Wales and Australian Capital Territory



Sydney



Canberra

1

1

Orange

3

2

Wollongong

2

3

Menangle

4

4

Newcastle

5

5









Port Macquarie

6

6

Jervis Bay

 Brisbane

-  St George
-  Rockhampton
-  Toowoomba
-  Sunshine Coast
-  Gold Coast
-  Dalby
-  Mt Tamborine
-  Mitchell

Queensland

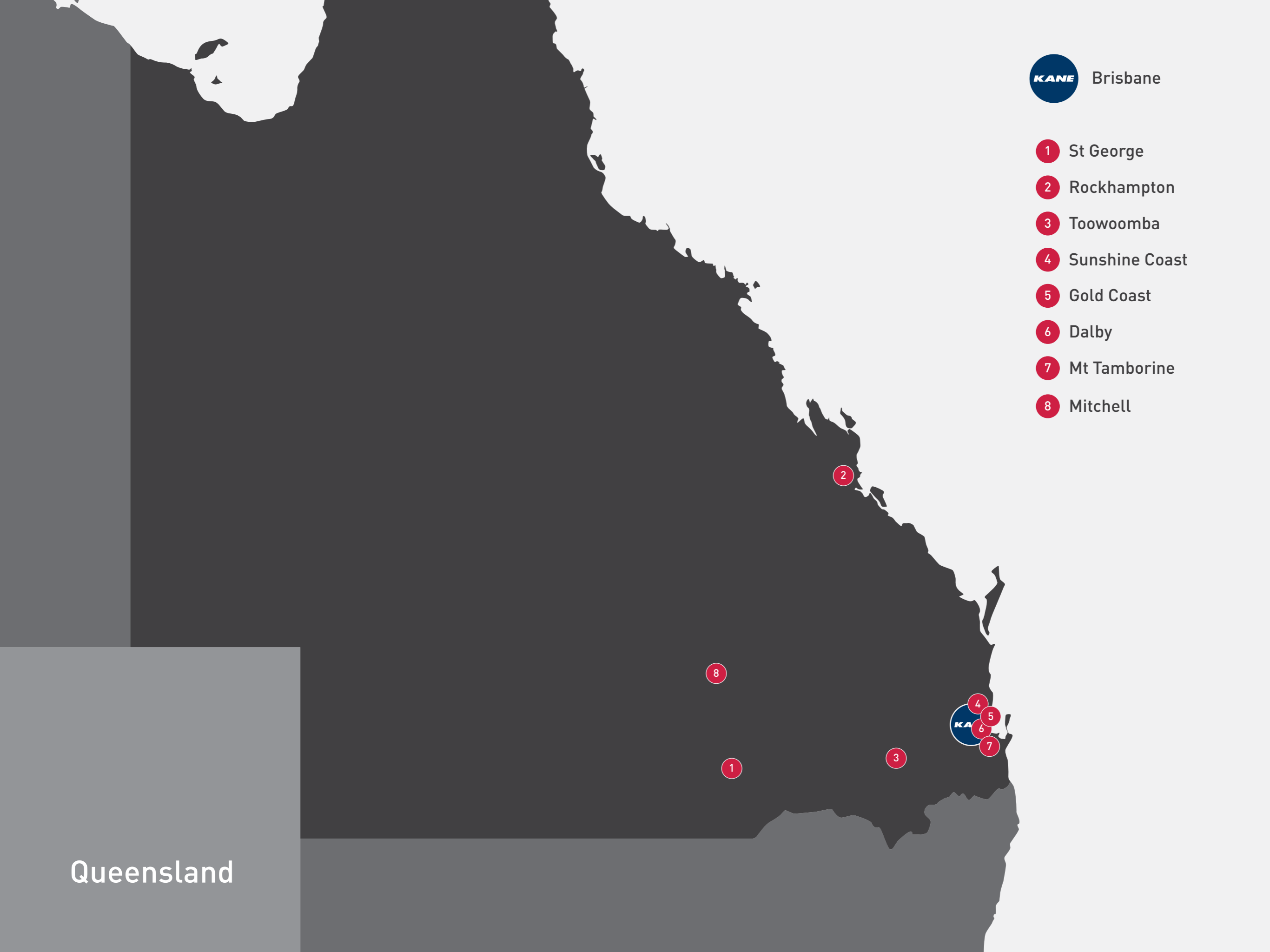

Tasmania



- 1 Launceston
- 2 Hobart
- 3 Fort Direction



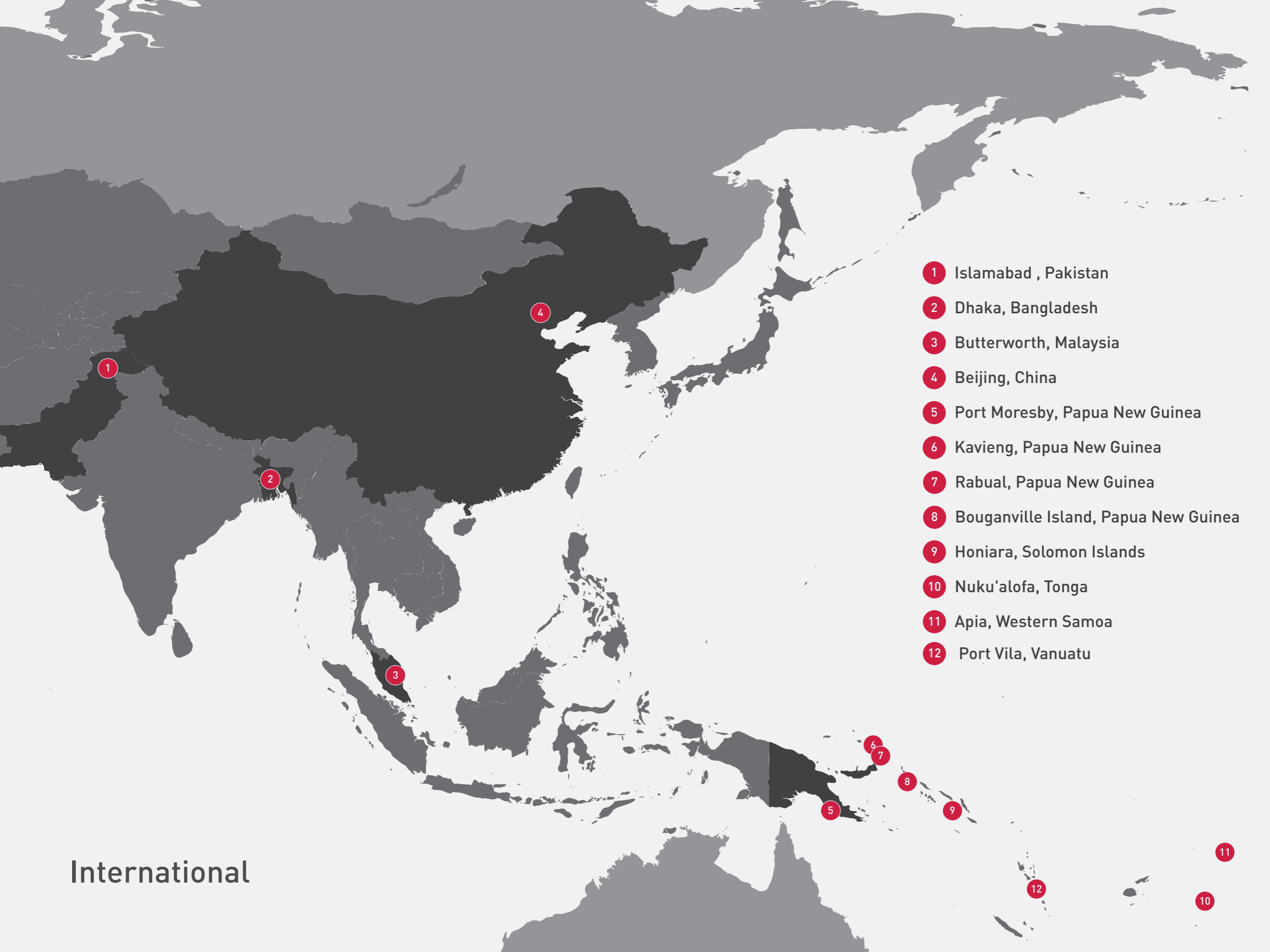

- 1 Islamabad , Pakistan
- 2 Dhaka, Bangladesh
- 3 Butterworth, Malaysia
- 4 Beijing, China
- 5 Port Moresby, Papua New Guinea
- 6 Kavieng, Papua New Guinea
- 7 Rabual, Papua New Guinea
- 8 Bouganville Island, Papua New Guinea
- 9 Honiara, Solomon Islands
- 10 Nuku'alofa, Tonga
- 11 Apia, Western Samoa
- 12 Port Vila, Vanuatu

International

# PROJECTS & PEOPLE





# Projects & People

The following sections provide a selection of projects delivered by Kane Constructions. Since commencing operations in 1973 we have completed over 1800 jobs across all sectors of the industry ranging in value from under \$1 million to over \$180 million.

We are proud of our work, which has been delivered in collaboration with our clients, design consultants, subcontractors and suppliers.

More importantly, our body of work could not have happened without great people.

# Projects & People



Kane staff are trained and empowered to take on new challenges and fulfil their potential. Professionalism, competence, integrity and enjoying what we do are the foundations of our culture; we know our business and believe in ourselves.

In an industry where transience is common, at Kane, great value is placed on long term employment and the sharing of experience.

---

|                  |            |            |            |
|------------------|------------|------------|------------|
| Years of service | <b>5+</b>  | <b>10+</b> | <b>20+</b> |
| Number of people | <b>129</b> | <b>62</b>  | <b>22</b>  |
| Percentage       | <b>51%</b> | <b>25%</b> | <b>9%</b>  |

---



# Work by Sector

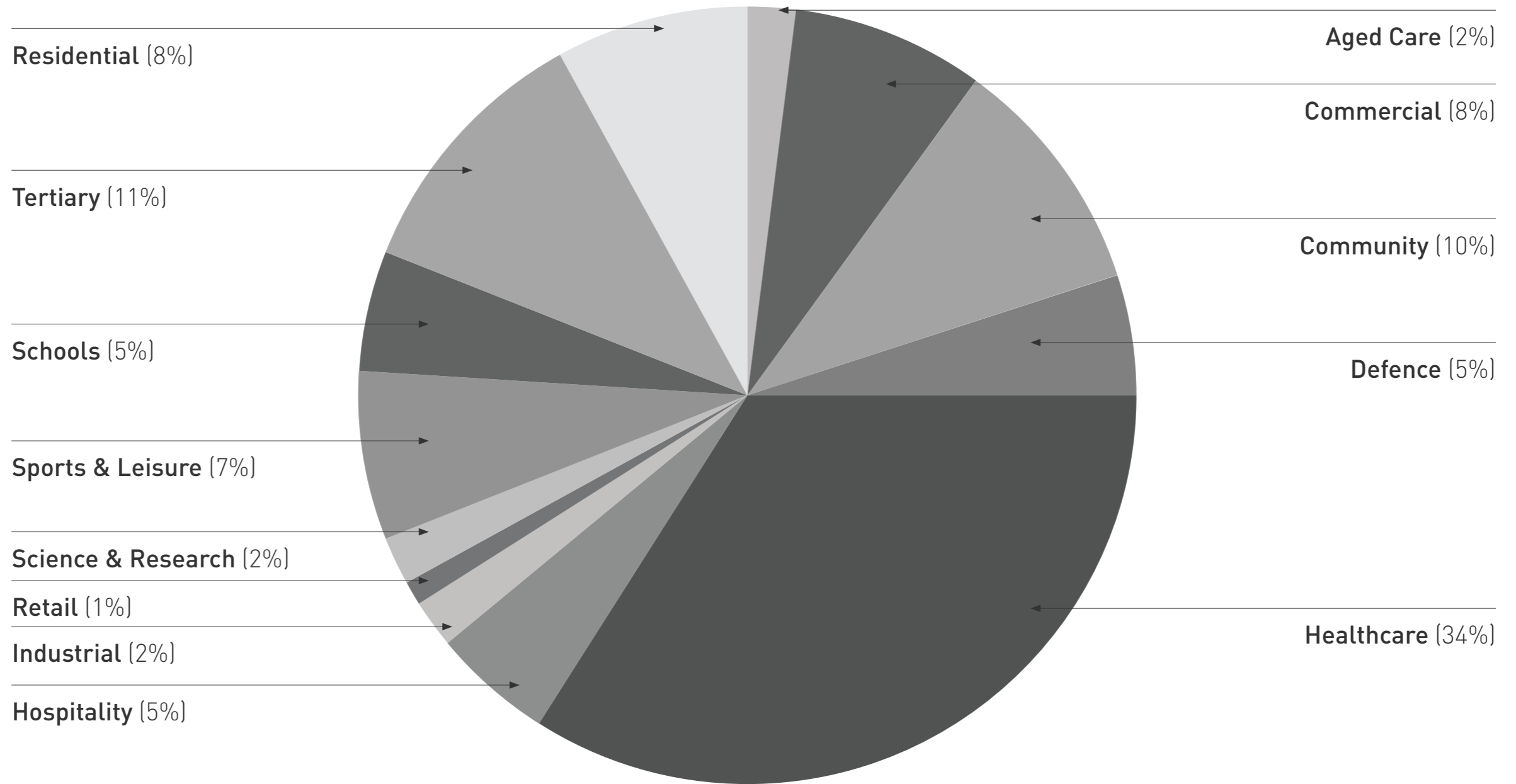

# Timeline

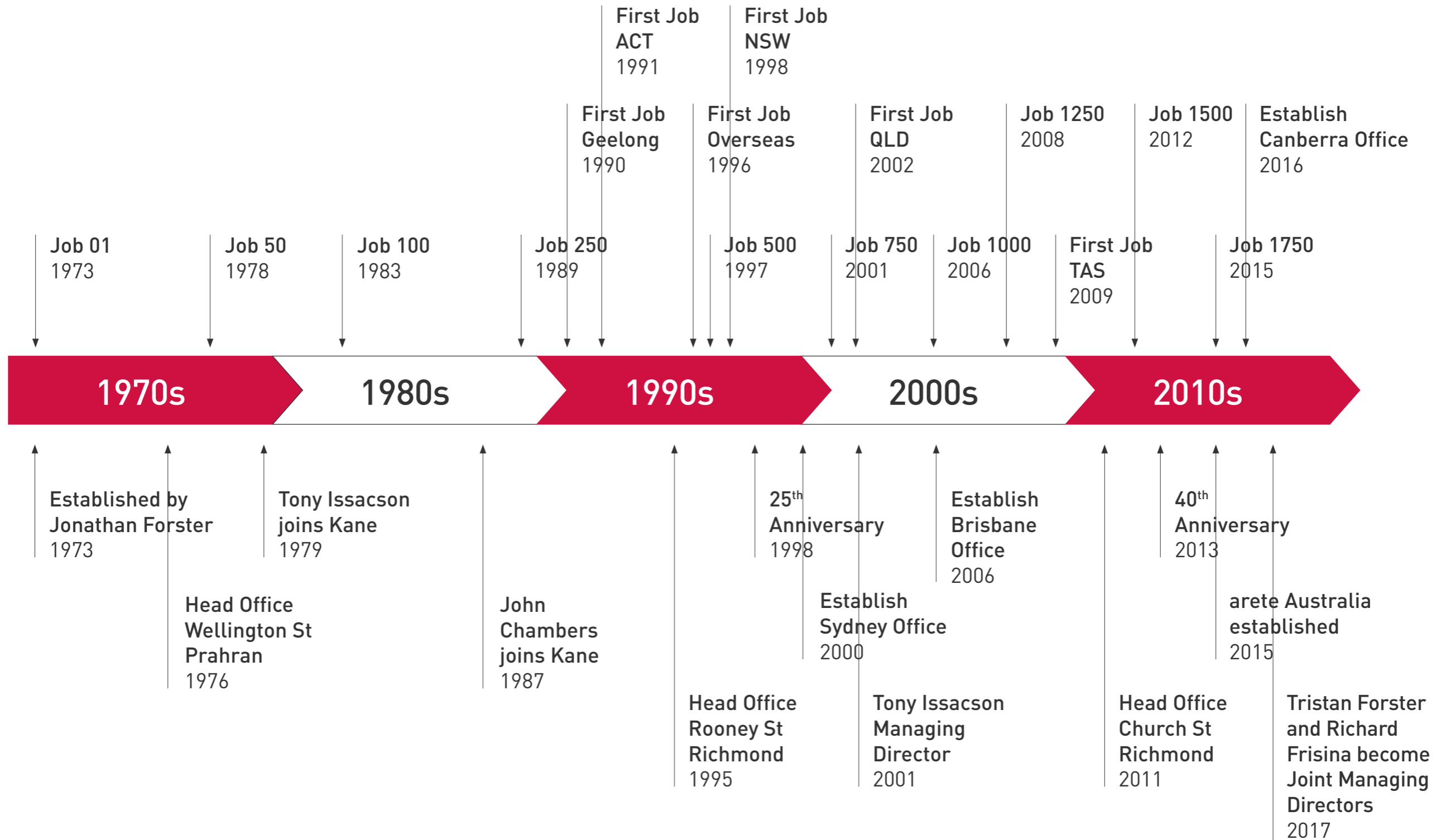

# PROJECTS

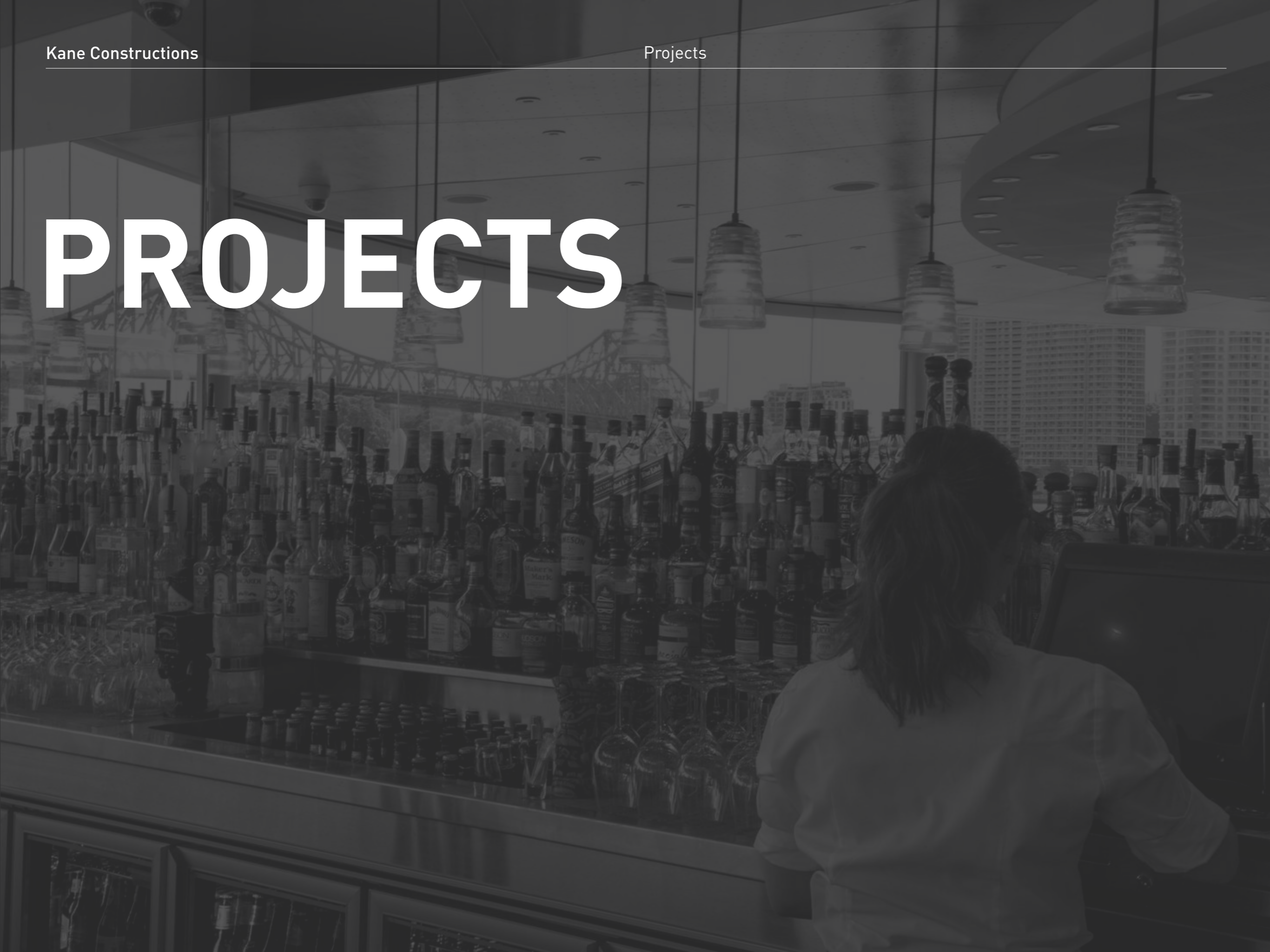



## RETAIL / HOSPITALITY

**Job Number:** 1908 / 2017

**Name:** Health City One

**Client:** Springfield Land Corporation

**Team:** Deicke Richards / ADG Engineers /  
BCA Consultants

**Location:** Queensland

**Value:** \$18m





# RETAIL / HOSPITALITY

**Job Number:** 1786 / 2018

**Name:** Cape Schanck Resort

**Client:** RACV

**Team:** Wood Marsh

**Location:** Victoria

**Value:** \$135m







## RETAIL / HOSPITALITY

**Job Number:** 1763 / 2016

**Name:** RACV Royal Pines Resort  
Children's Pool & Waterpark

**Client:** RACV

**Team:** Ocean Park Consulting

**Location:** Queensland

**Value:** \$4m





## RETAIL / HOSPITALITY

**Job Number:** 1748 / 2015

**Name:** Cold Rock

**Client:** Cold Rock

**Team:** Alto Architects

**Location:** Queensland

**Value:** \$1m







## RETAIL / HOSPITALITY

**Job Number:** 1730 / 2015

**Name:** Journeys Kitchen & Bar

**Client:** Journeys Kitchen & Bar

**Location:** Queensland

**Value:** ← \$1m





## RETAIL / HOSPITALITY

**Job Number:** 1698 / 2015

**Name:** Lilian's Café, St Vincent's Hospital

**Client:** Zouki

**Team:** Red Design Group

**Location:** Queensland

**Value:** ← \$1m





## RETAIL / HOSPITALITY

**Job Number:** 1612 / 2013

**Name:** Royal Pines Resort One Spa

**Client:** RACV

**Team:** Accuraco / Peddle Thorp Architects

**Location:** Queensland

**Value:** \$7m



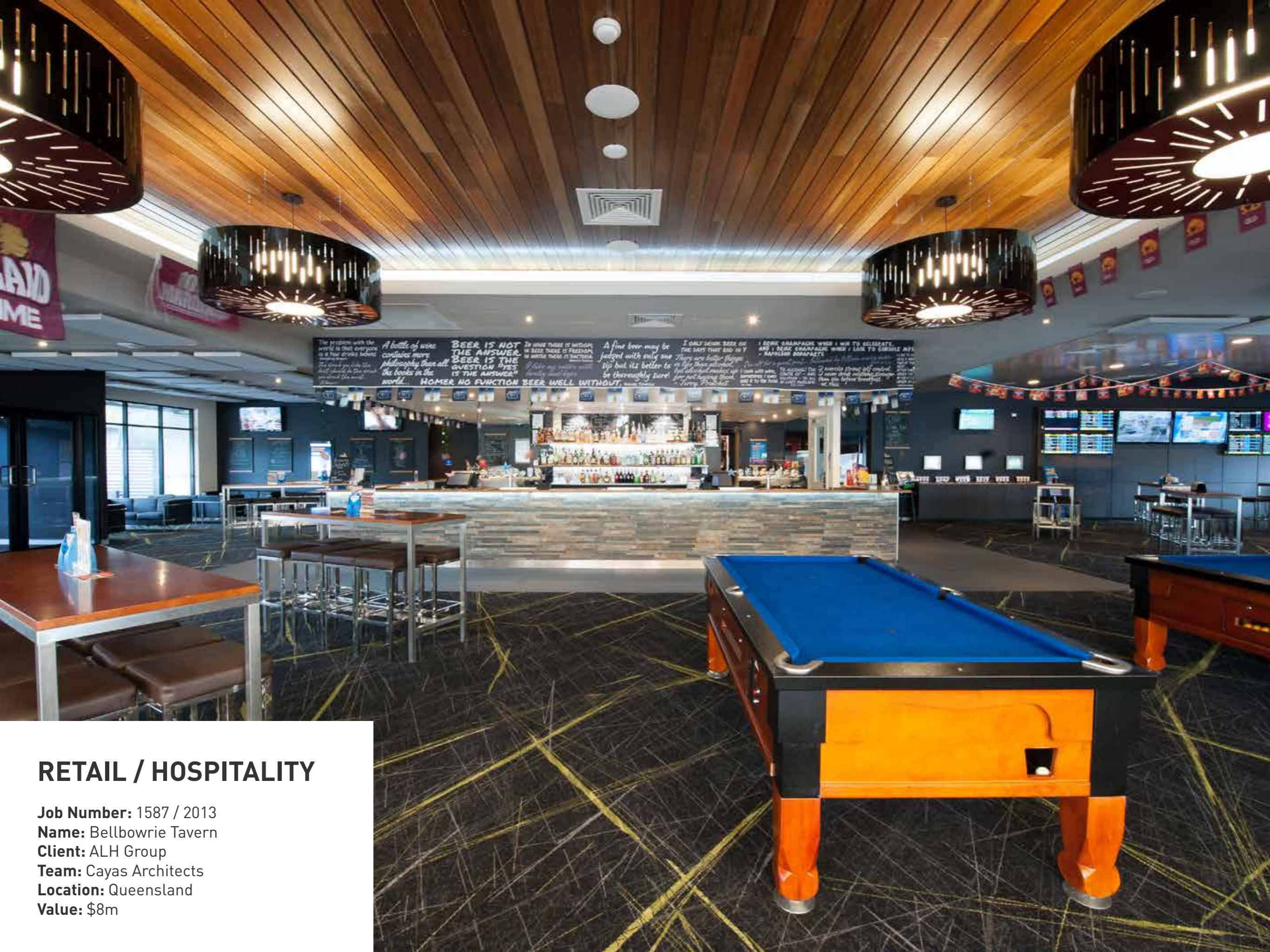

## RETAIL / HOSPITALITY

**Job Number:** 1587 / 2013  
**Name:** Bellbowrie Tavern  
**Client:** ALH Group  
**Team:** Cayas Architects  
**Location:** Queensland  
**Value:** \$8m



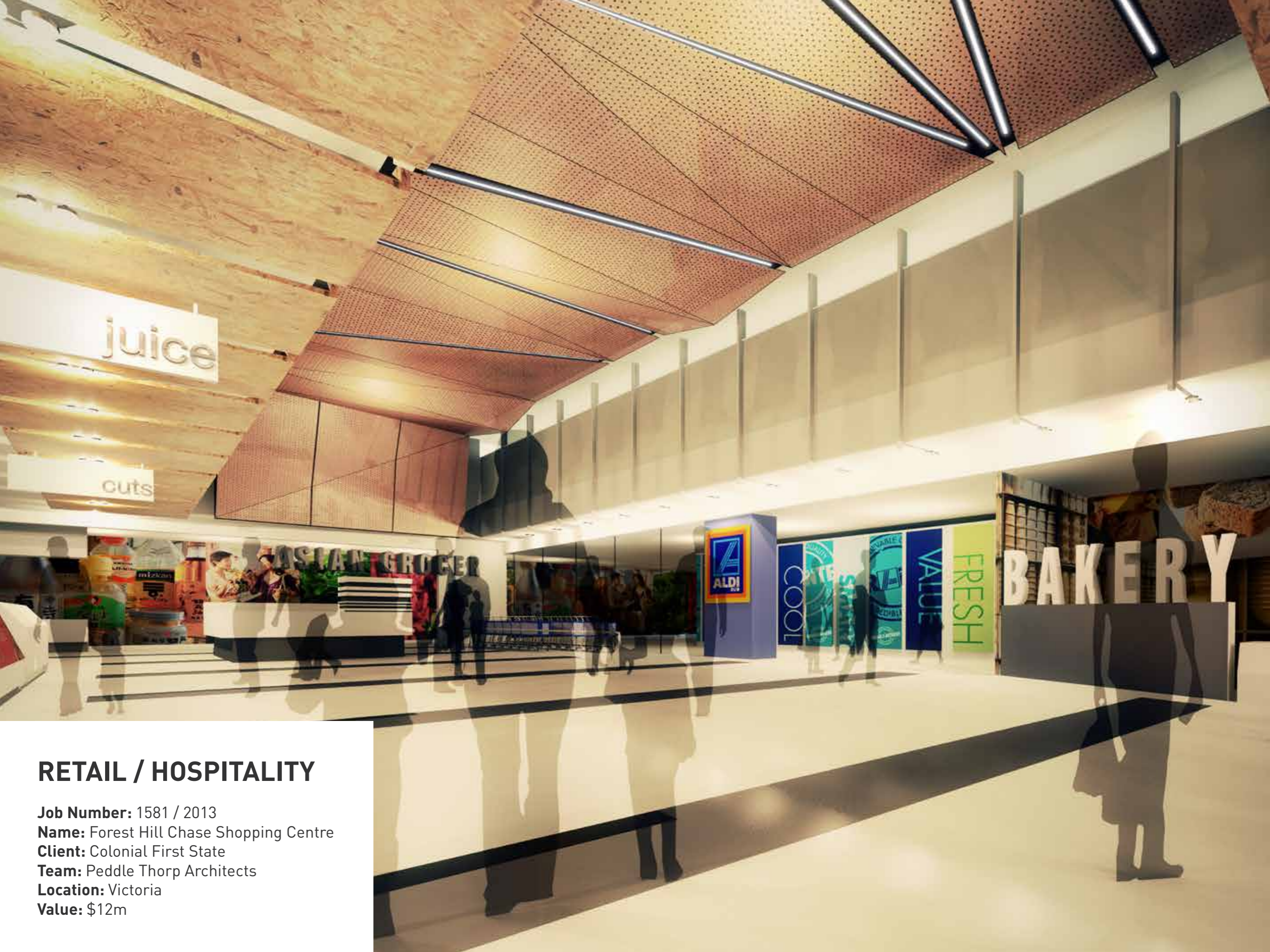

## RETAIL / HOSPITALITY

**Job Number:** 1581 / 2013

**Name:** Forest Hill Chase Shopping Centre

**Client:** Colonial First State

**Team:** Peddle Thorp Architects

**Location:** Victoria

**Value:** \$12m





## RETAIL / HOSPITALITY

**Job Number:** 1557 / 2012

**Name:** Il Centro Bar and Awning Works

**Client:** Stockland

**Team:** POWE Architects

**Location:** Queensland

**Value:** \$2m



## RETAIL / HOSPITALITY

**Job Number:** 1508 / 2011

**Name:** User Accomodation Building

**Client:** Australian Synchrotron

**Team:** Architectus

**Location:** Victoria

**Value:** \$30m





## RETAIL / HOSPITALITY

**Job Number:** 1500 / 2013

**Name:** Torquay Resort

**Client:** RACV

**Team:** Coffey Projects / Wood Marsh

**Location:** Victoria

**Value:** \$115m





# RETAIL / HOSPITALITY

**Job Number:** 1347 / 2011

**Name:** Number 8

**Client:** GLG Developments

**Team:** Clarke Hopkins Clarke

**Location:** Victoria

**Value:** \$22m







## RETAIL / HOSPITALITY

**Job Number:** 1341 / 2010

**Name:** Novotel on Collins

**Client:** Thakral Group

**Team:** Sweet Group /  
Perrot Lyon Mathieson

**Location:** Victoria

**Value:** \$25m





## RETAIL / HOSPITALITY

**Job Number:** 1341 / 2010  
**Name:** Australia on Collins  
**Client:** Thakral Group  
**Team:** Sweet Group /  
Perrot Lyon Mathieson  
**Location:** Victoria  
**Value:** \$3m





## RETAIL / HOSPITALITY

**Job Number:** 1329 / 2009

**Name:** The Residence, Grand Hyatt

**Client:** Grand Hotels Group

**Team:** Nash Management /  
Graphos Architects

**Location:** Victoria

**Value:** \$7m



The image shows a spacious, modern lounge area within a yacht club. The room features a curved ceiling with recessed lighting and a large window wall on the left side, offering a view of the ocean and numerous sailboats. In the foreground, there are several tables with chairs. To the right, a long bar with a white and wood-grain facade is visible, with a bartender standing behind it. The bar area is well-lit and has a display of bottles. The overall atmosphere is bright and contemporary.

## RETAIL / HOSPITALITY

**Job Number:** 1267 / 2009

**Name:** Sandringham Yacht Club

**Client:** Sandringham Yacht Club

**Team:** Richard Mabin Architecture

**Location:** Victoria

**Value:** \$10m





## RETAIL / HOSPITALITY

**Job Number:** 1266 / 2008

**Name:** Guiseppe Arnaldo & Sons

**Client:** Crown Limited

**Team:** Lazzarini Pickering Architetti

**Location:** Victoria

**Value:** \$5m





## RETAIL / HOSPITALITY

**Job Number:** 1258 / 2008

**Name:** Grand Hyatt Melbourne

**Client:** Grand Hotels Group

**Team:** Billard Leece Partnership

**Location:** Victoria

**Value:** \$20m



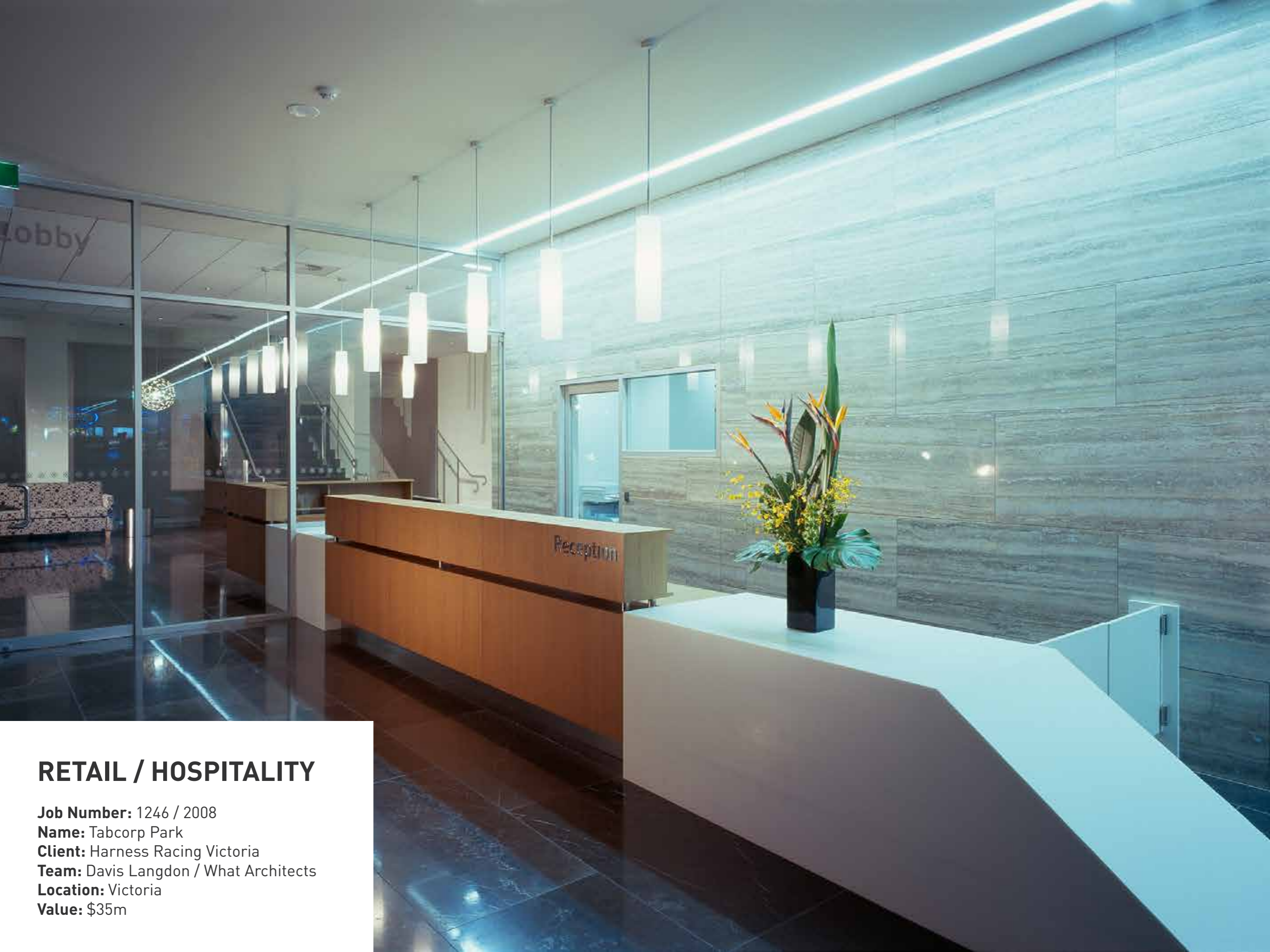

## RETAIL / HOSPITALITY

**Job Number:** 1246 / 2008

**Name:** Tabcorp Park

**Client:** Harness Racing Victoria

**Team:** Davis Langdon / What Architects

**Location:** Victoria

**Value:** \$35m



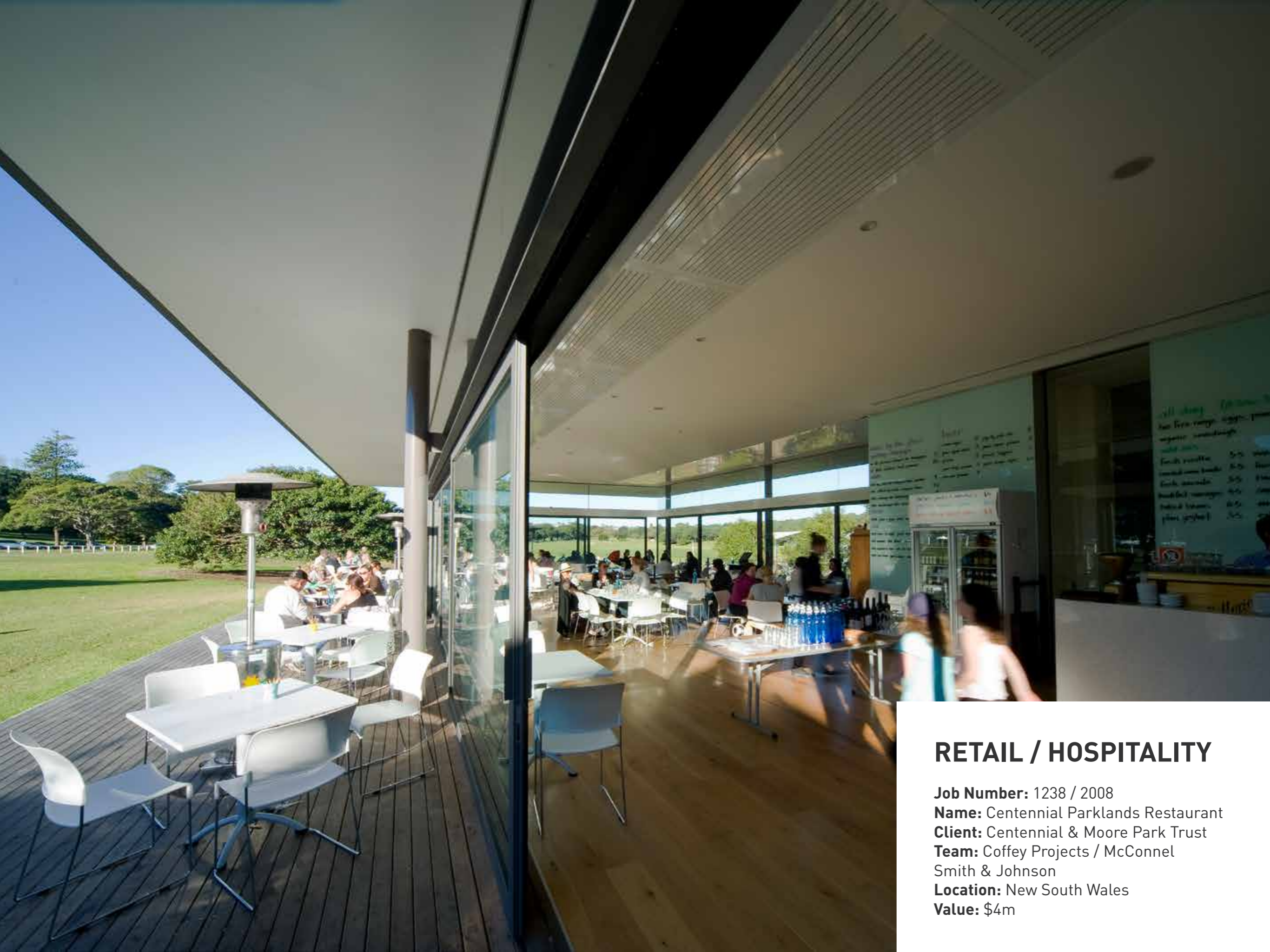

## RETAIL / HOSPITALITY

**Job Number:** 1238 / 2008

**Name:** Centennial Parklands Restaurant

**Client:** Centennial & Moore Park Trust

**Team:** Coffey Projects / McConnell  
Smith & Johnson

**Location:** New South Wales

**Value:** \$4m





## RETAIL / HOSPITALITY

**Job Number:** 1193 / 2007

**Name:** City Club

**Client:** RACV

**Team:** Davis Langdon / Peddle Thorp  
Architects

**Location:** Victoria

**Value:** \$12m





## RETAIL / HOSPITALITY

**Job Number:** 582 / 1998  
**Name:** Kerferd Road Kiosk  
**Client:** Kerferd Road Catering  
**Team:** Peter Mills and Associates  
**Location:** Victoria  
**Value:** \$1m



## RETAIL / HOSPITALITY

**Job Number:** 642 / 2000

**Name:** BMW South Yarra

**Client:** Bib Stilwell BMW

**Team:** ERA 2000 Architects

**Location:** Victoria

**Value:** \$4m



## RETAIL / HOSPITALITY

**Job Number:** 862 / 2002

**Name:** Mini Dealership

**Client:** Col Crawford Motors

**Team:** Humel Architects

**Location:** New South Wales

**Value:** \$4m







## RETAIL / HOSPITALITY

**Job Number:** 479 / 1996

**Name:** Carlton Brewhouse

**Client:** Carlton United Breweries

**Team:** James W Sadler

**Location:** Victoria

**Value:** \$4m





## RETAIL / HOSPITALITY

**Job Number:** 450 / 1996  
**Name:** The Point Restaurant  
**Client:** Private  
**Team:** Maddison Architects  
**Location:** Victoria  
**Value:** \$3m





## RETAIL / HOSPITALITY

**Job Number:** Various

**Name:** ALDI Stores

**Client:** ALDI Stores

**Team:** Various

**Location:** Victoria

**Value:** \$40m+



# Kane Constructions

kane.com.au

## VICTORIA

Jonathan Angelopoulos

0430 369 499

jange@kane.com.au

## NEW SOUTH WALES

Dominic Begley

0434 735 033

dbegley@kane.com.au

## QUEENSLAND

Lauri Brown

0447 231 838

lbrown@kane.com.au

## AUSTRALIAN CAPITAL TERRITORY

Jon Anastasov

0468 988 207

janastasov@kane.com.au