

KANIE

SECTOR: SCHOOLS

SIR ZELMAN COWEN
CENTRE FOR SCIENCE

A photograph of a modern school building with a large staircase and students walking. The building has a prominent entrance with a large glass facade and a sign that reads "SIR ZELMAN COWEN CENTRE FOR SCIENCE". The scene is set against a clear blue sky. The overall image has a blue tint.

ABOUT US



Who We Are

We are a privately owned commercial construction company active in all sectors of the industry. With a turnover in excess of \$800 million and over 400 full time employees, we operate throughout the east coast of Australia and overseas from offices in Melbourne, Sydney, Brisbane and Canberra.

‘Our success is recognised in the way we achieve, as much as what we achieve.’



People

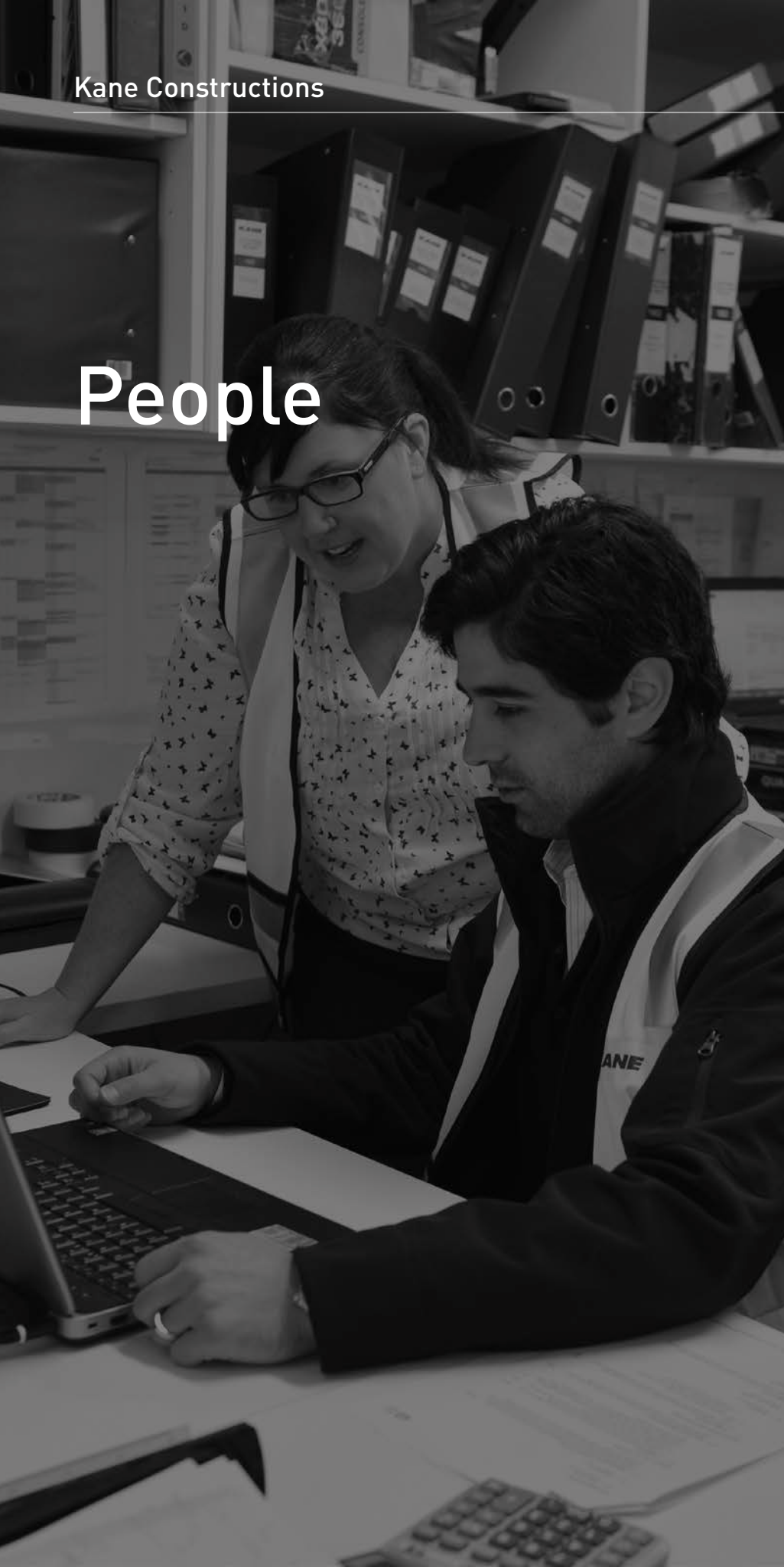

Our greatest asset is our people.

We engage and promote those with appropriate skills, experience and technical qualifications within a 'flat and open' management structure. Graduates in building, engineering and architecture occupy project management, technical management and contract administration positions.

Careful staff selection ensures Site Managers and Foreman of the highest calibre make up the on-site teams. Teamwork, backed by effective communication systems and administration resources, ensures a highly motivated approach to the most challenging projects.

Board of Directors



Jonathan Forster
Chairman



Richard Frisina
Joint Managing Director



Tristan Forster
Joint Managing Director



Julian Hamilton
Director



Tony Isaacson
Director



Geoff Purcell
Director



David Rutter
Director



Richard Sutterby
Director



Steve Theisz
Director

Organisational Structure

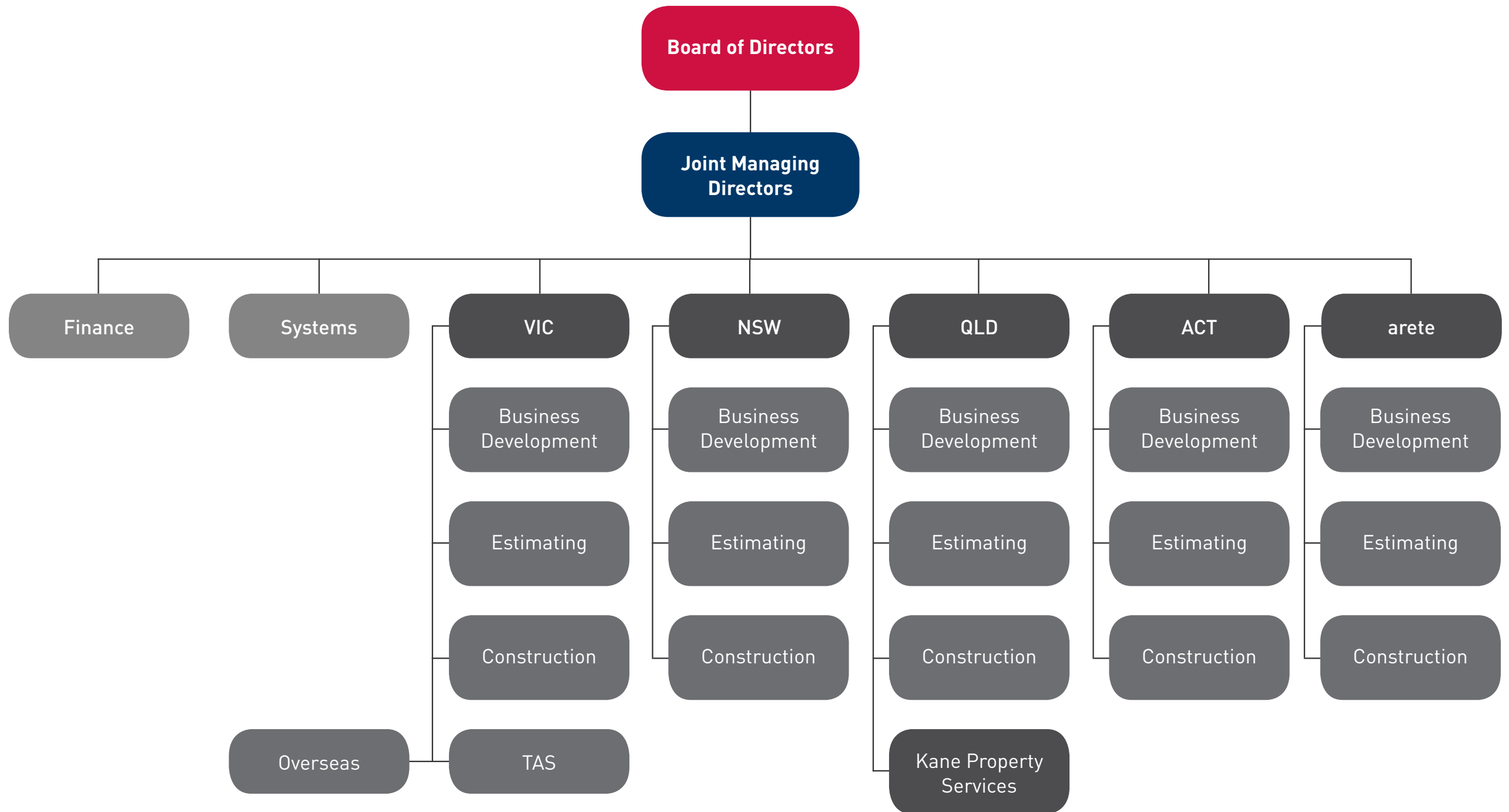

Financials

For over 40 years through the ups and downs of the building cycle, Kane Constructions has achieved steady and sustainable growth. With annual turnover in excess of \$800 million, the company is well placed to take on a mix of short, medium and longer term projects in the \$1 million to \$200 million value range.

With a strong balance sheet, no debt and significant cash reserves Kane offers its clients and their advisors financial assurance in relation to project delivery.

The construction group has total assets exceeding \$150 million with a security facility to cater for well over \$1 billion of work under construction.

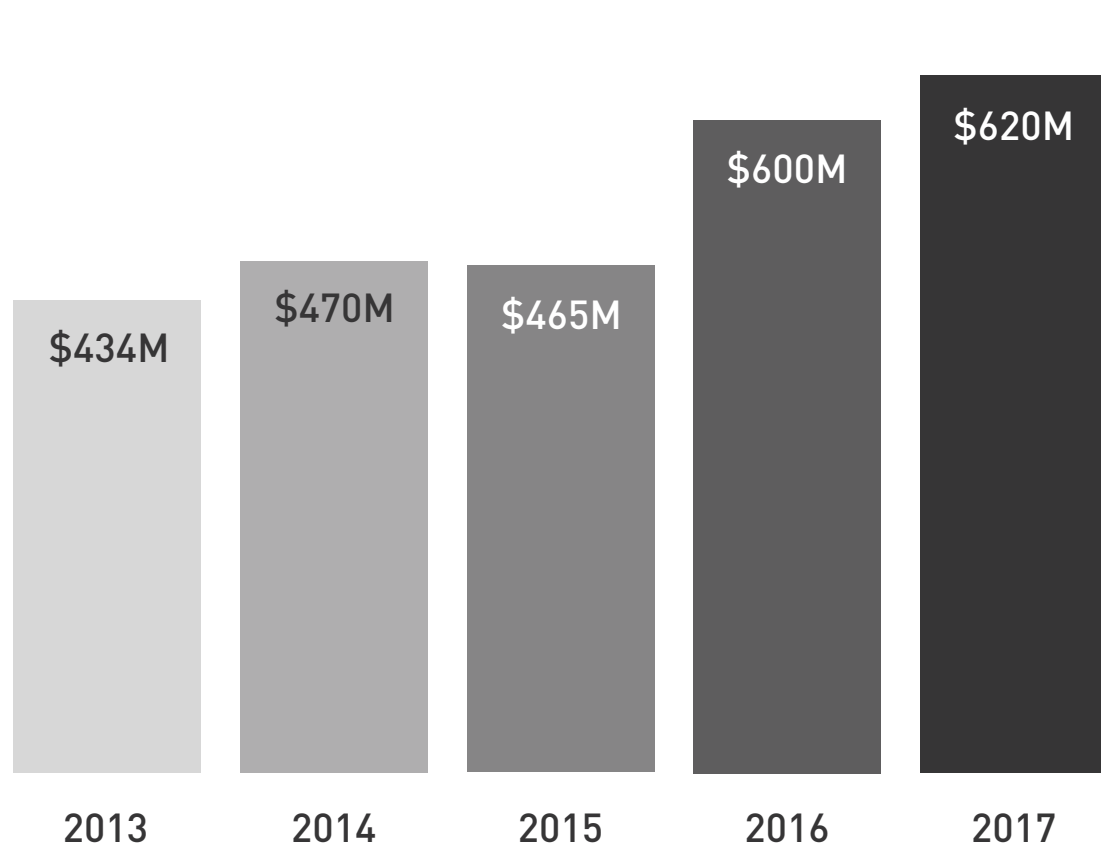

Revenue

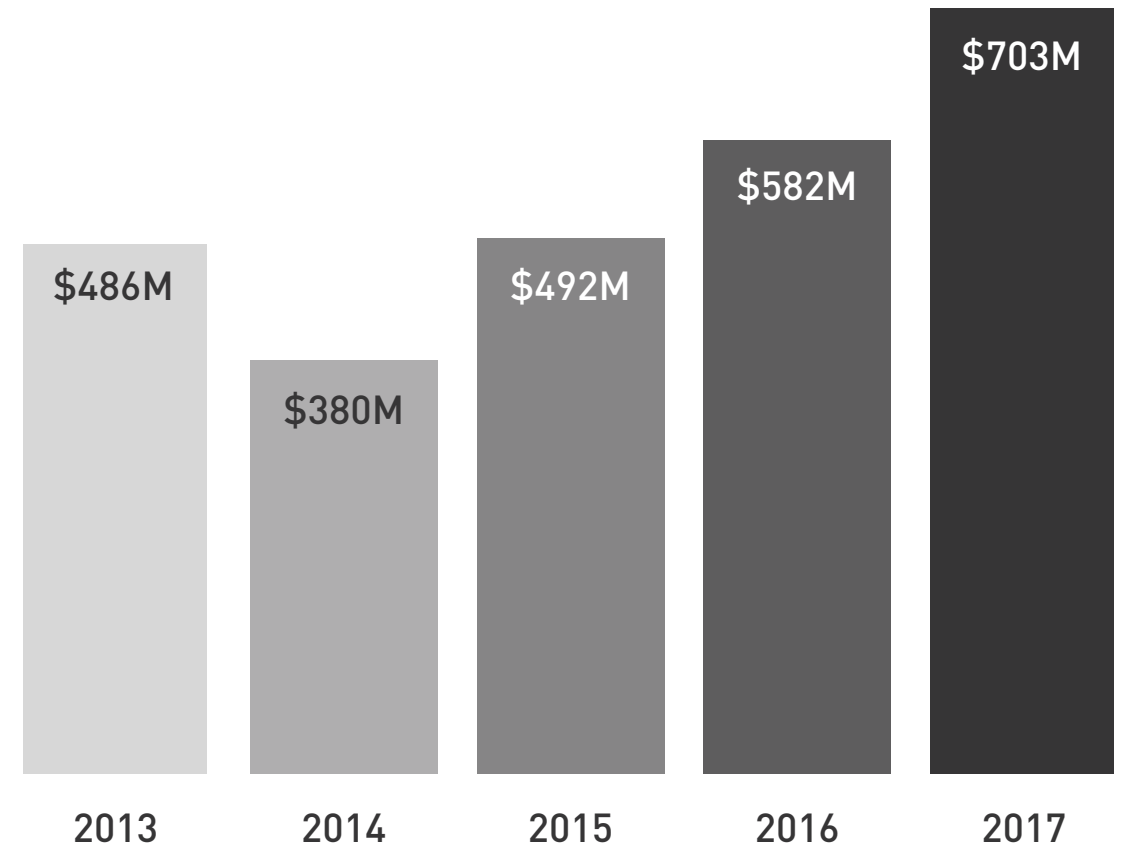

Contracts Awarded

\$815M

WORK IN HAND

44

LIVE PROJECTS

\$115M

BANK GUARANTEE /
BONDING FACILITY

\$95M

CASH ON HAND



Accreditation



Occupational Health & Safety Management System certified to AS/NZS 4801



Quality Assurance Management System certified to AS/NZS ISO 9001



Environmental Management System is certified to AS/NZS ISO 14001



Australian Government Building and Construction OHS Accreditation Scheme



National Prequalification System for Non-Residential Building for \$50 million and above

Green Star

Project Name	State		Client	Finish
01 — University of Melbourne Arts West Redevelopment	VIC	Registered for 5 Star Green Star - Education Design v1	University of Melbourne	2016
02 — Geelong Library & Heritage Centre	VIC	5 Star Green Star - Public Building Design v1	City of Greater Geelong	2015
03 — La Trobe University Sylvia Walton Building	VIC	5 Star Green Star - Education Design v1	La Trobe University	2014
04 — GE Headquarters, Springfield	QLD	5 Star Green Star - Office Design v3	Springfield Land Corporation	2014
05 — Victoria University, Construction Futures	VIC	6 Star Green Star - Education Design v1	Victoria University	2012
06 — La Trobe Rural Health - Health Sciences Building	VIC	5 Star Green Star Education v1	La Trobe University	2012
07 — La Trobe Rural Health - Clinical Teaching Building	VIC	5 Star Green Star Education v1	La Trobe University	2012
08 — MC2 Manningham City Square	VIC	5 Star Green Star - Public Building PILOT	Manningham City Council	2012
09 — National Centre for Synchrotron Science	VIC	5 Star Green Star - Education Design v1	Australian Synchrotron	2012
10 — Kane Constructions Brisbane Office	QLD	5 Star Green Star - Office Design v3	Kane Constructions	2011
11 — Dandiiri Contact Centre Photovoltaic Array	QLD	6 Star Green Star - Office Design v2	Project Services	2011
12 — Swinburne University, Advanced Technology Centre	VIC	5 Star Green Star - Education Design v1	Swinburne University of Technology	2011
13 — Brisbane City Hall Restoration (Stage 1)	QLD	4 Star Green Star Public Building Design PILOT	Brisbane City Council	2010
14 — RMIT University Building 1	VIC	5 Star Green Star - Office Design v2	RMIT University	2010



2016 Awards



Master Builders Australia

National Commercial Master Builder of the Year
Geelong Library and Heritage Centre, National Commercial/Industrial Construction
\$20M-\$50M

Master Builders Association of Victoria

Young Builder of the Year – David Purcell

Master Builder of the Year

Geelong Library & Heritage Centre, Excellence in Construction of Commercial Buildings
\$30M-\$80M

Epworth Richmond Lee Wing Main Works, Excellence in Construction of Commercial Buildings over \$80M

Master Builders Association of Queensland

Riverside Centre Vertical Village - Queensland Master Builders Housing & Construction Award Commercial Building up to \$5m

National Association of Women in Construction

High Commendation - Crystal Vision Award for Advancing the Interests of Women in the Construction Industry - Monica Fontaine

2016 Awards



Australian Institute of Building, National

Building Professional of the Year – David Purcell

Geelong Library & Heritage Centre, Professional Excellence Commercial Constructions
\$10M-\$50M

Australian Institute of Building, Victorian Chapter

Building Professional of the Year – David Purcell

Geelong Library & Heritage Centre, Professional Excellence Commercial Constructions
\$10M-\$50M

Aquation, High Commendation Commercial Construction \$10M-\$50M

MPavilion 2015, High Commendation Research Development & Technology

Australian Institute of Architects, Victorian Chapter

Geelong Library & Heritage Centre, The Victorian Architecture Medal

Geelong Library & Heritage Centre, The Marion Mahony Award for Interior Architecture

Geelong Library & Heritage Centre, The William Wardell Award for Public Architecture

Geelong Library & Heritage Centre, The Regional Prize

2015 Awards



Master Builders Association of Victoria

Young Builder of the Year – Tim Fowler

Owen Dixon Chambers West, Excellence in Construction of Commercial Buildings
\$20M-\$30M

Australian Institute of Architects, Victorian Chapter

MPavilion, Small Project Architecture Award - Kevin Borland Award for Small
Project Architecture

RACV Torquay Resort, Commercial Architecture Commendation

La Trobe University Sylvia Walton Building, Educational
Architecture Commendation

Master Builders Association of New South Wales

Blue Mountains Theatre & Community Hub, Excellence in Construction Awards -
Refurbishment/Renovation/Extension \$15M-\$50M

2015 Awards



Australian Institute of Architects, New South Wales Chapter

Tamarama Kiosk & Services Building, Urban Design - Lloyd Rees Award

Master Builders Association of Queensland

GE Headquarters Base Building & Integrated Fitout, Springfield, Excellence in Construction Awards - Commercial Buildings over \$5M

National Trust Queensland

Anzac Square Restoration Stage 2, Conservation Works, Gold

Queensland Rail's Roma Street Station Stage 1 Roof Restoration, Conservation Works, Gold

Government House Equitable Access, Highly Commended



Social & Community

Work hard. Play hard. Give something back.



WHERE WE OPERATE



Where We Operate

We operate throughout the east coast of Australia and overseas from offices in Melbourne, Sydney, Brisbane and Canberra.

Our head office is located in Melbourne from where we service both our metropolitan projects and our regional operations. Tasmania is also resourced from the Melbourne office.

Projects in New South Wales and the Australian Capital Territory are resourced from our Sydney and Canberra offices. Regional work is undertaken primarily along the north and south coast.

From our Brisbane office we service the Sunshine Coast and the Gold Coast. We have also delivered projects in Rockhampton and as far west as St George.

We have completed a range of International projects primarily for AusAID, Department of Foreign Affairs and Trade and Department of Defence.



- 1 Nhill
- 2 Hamilton
- 3 Horsham
- 4 Mildura
- 5 Warrnambool
- 6 Hopetoun
- 7 Ararat
- 8 Swan Hill
- 9 Ballarat
- 10 Maryborough
- 11 Torquay
- 12 Geelong
- 13 Castlemaine
- 14 Bendigo
- 15 Rochester
- 16 Queenscliff
- 17 Echuca
- 18 Portsea
- 19 Sorrento
- 20 Puckapunyal
- 21 Mornington
- 22 Cobram
- 23 Warragul
- 24 Leongatha
- 25 Moe
- 26 Tidal River
- 27 Morwell
- 28 Ararat
- 29 Wangaratta
- 30 Sale
- 31 Numerkah



Victoria

New South Wales and Australian Capital Territory



Sydney



Canberra

1

1

Orange

3

2

Wollongong

2

3

Menangle

4

4

Newcastle

5

5









Port Macquarie

6

6

Jervis Bay

 Brisbane

-  St George
-  Rockhampton
-  Toowoomba
-  Sunshine Coast
-  Gold Coast
-  Dalby
-  Mt Tamborine
-  Mitchell

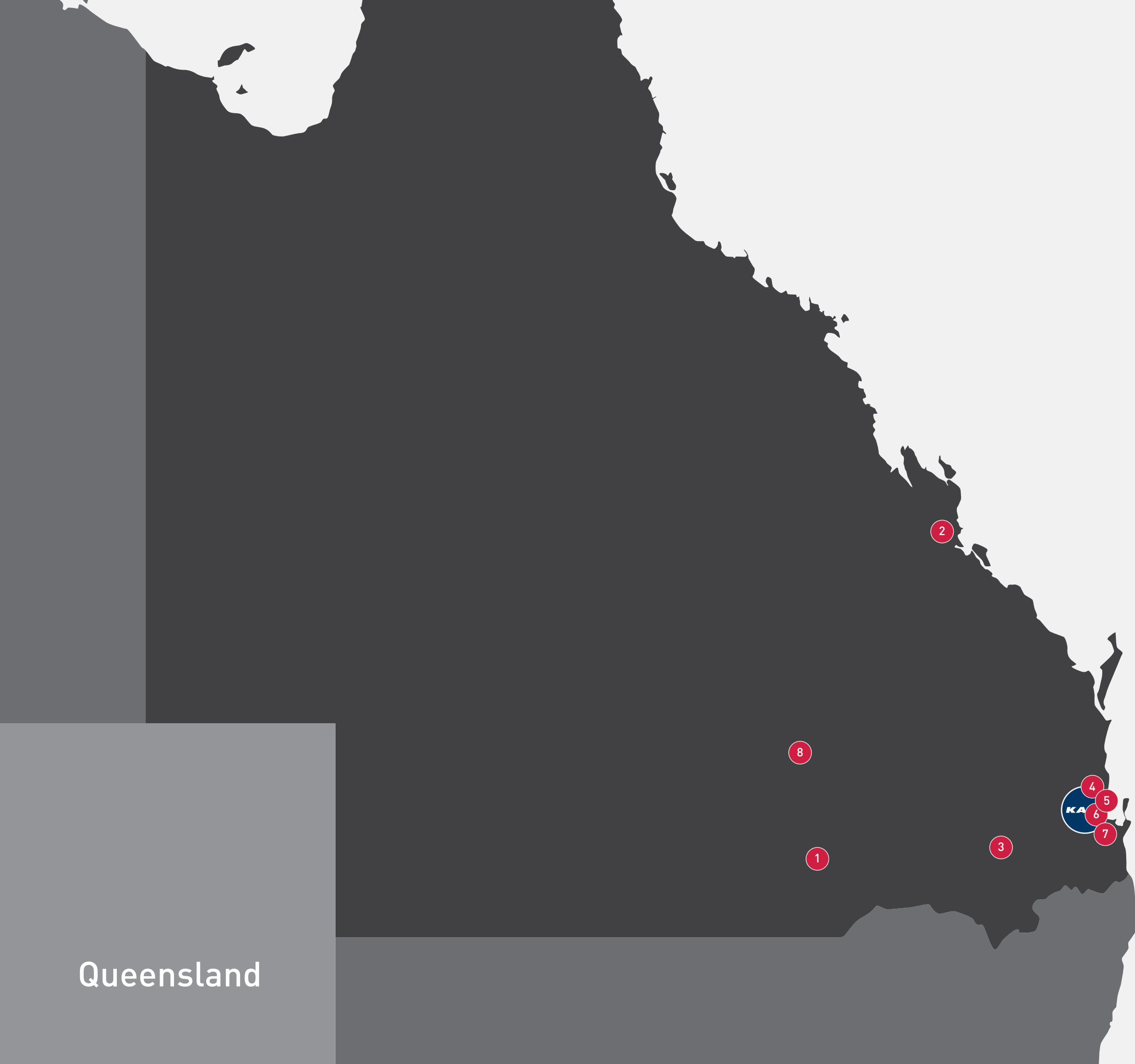

Queensland

Tasmania



- 1 Launceston
- 2 Hobart
- 3 Fort Direction

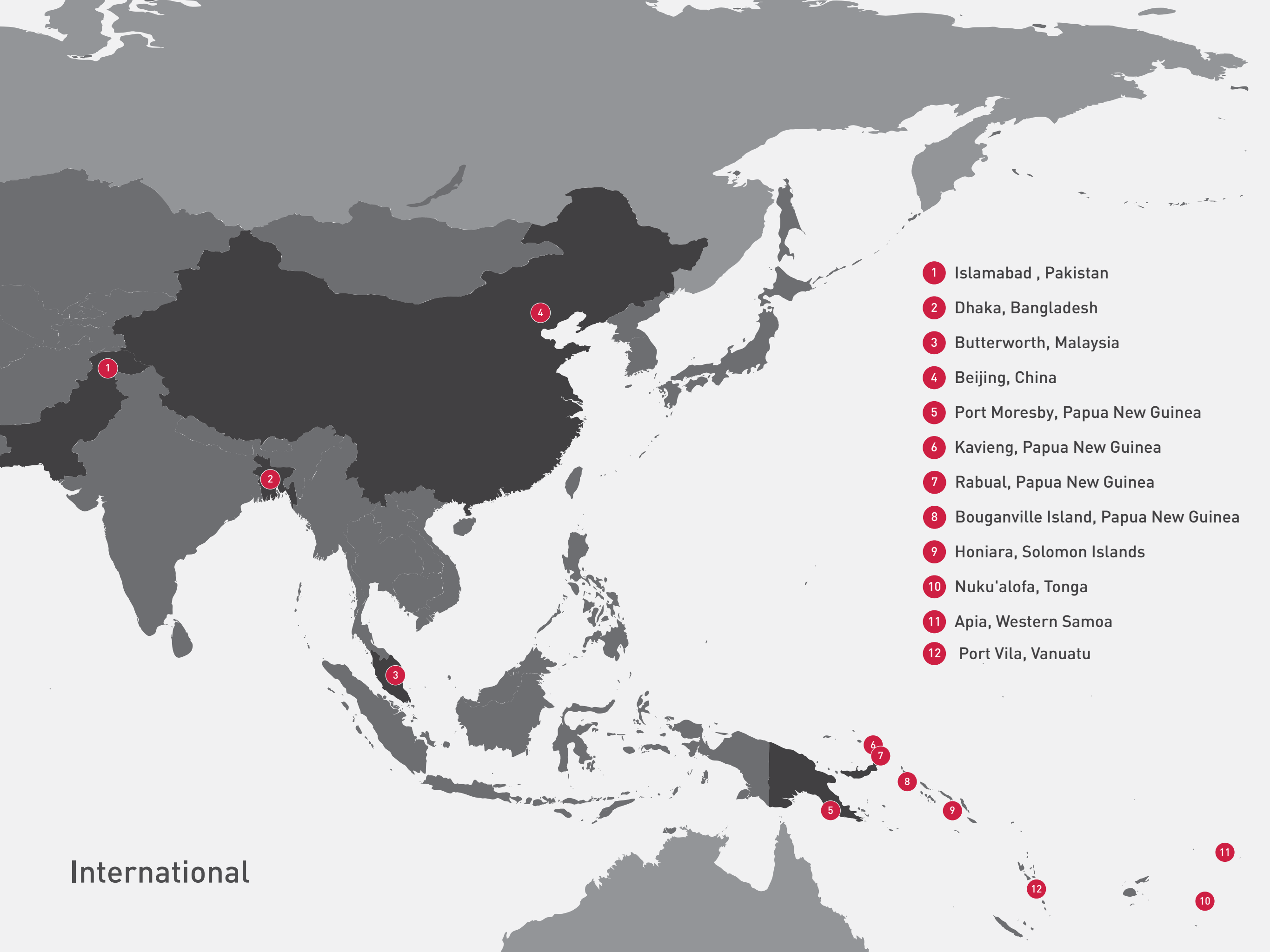

- 1 Islamabad , Pakistan
- 2 Dhaka, Bangladesh
- 3 Butterworth, Malaysia
- 4 Beijing, China
- 5 Port Moresby, Papua New Guinea
- 6 Kavieng, Papua New Guinea
- 7 Rabual, Papua New Guinea
- 8 Bouganville Island, Papua New Guinea
- 9 Honiara, Solomon Islands
- 10 Nuku'alofa, Tonga
- 11 Apia, Western Samoa
- 12 Port Vila, Vanuatu

International

PROJECTS & PEOPLE



Projects & People

The following sections provide a selection of projects delivered by Kane Constructions. Since commencing operations in 1973 we have completed over 1800 jobs across all sectors of the industry ranging in value from under \$1 million to over \$180 million.

We are proud of our work, which has been delivered in collaboration with our clients, design consultants, subcontractors and suppliers.

More importantly, our body of work could not have happened without great people.

Projects & People



Kane staff are trained and empowered to take on new challenges and fulfil their potential. Professionalism, competence, integrity and enjoying what we do are the foundations of our culture; we know our business and believe in ourselves.

In an industry where transience is common, at Kane, great value is placed on long term employment and the sharing of experience.

Years of service	5+	10+	20+
Number of people	129	62	22
Percentage	51%	25%	9%

Work by Sector

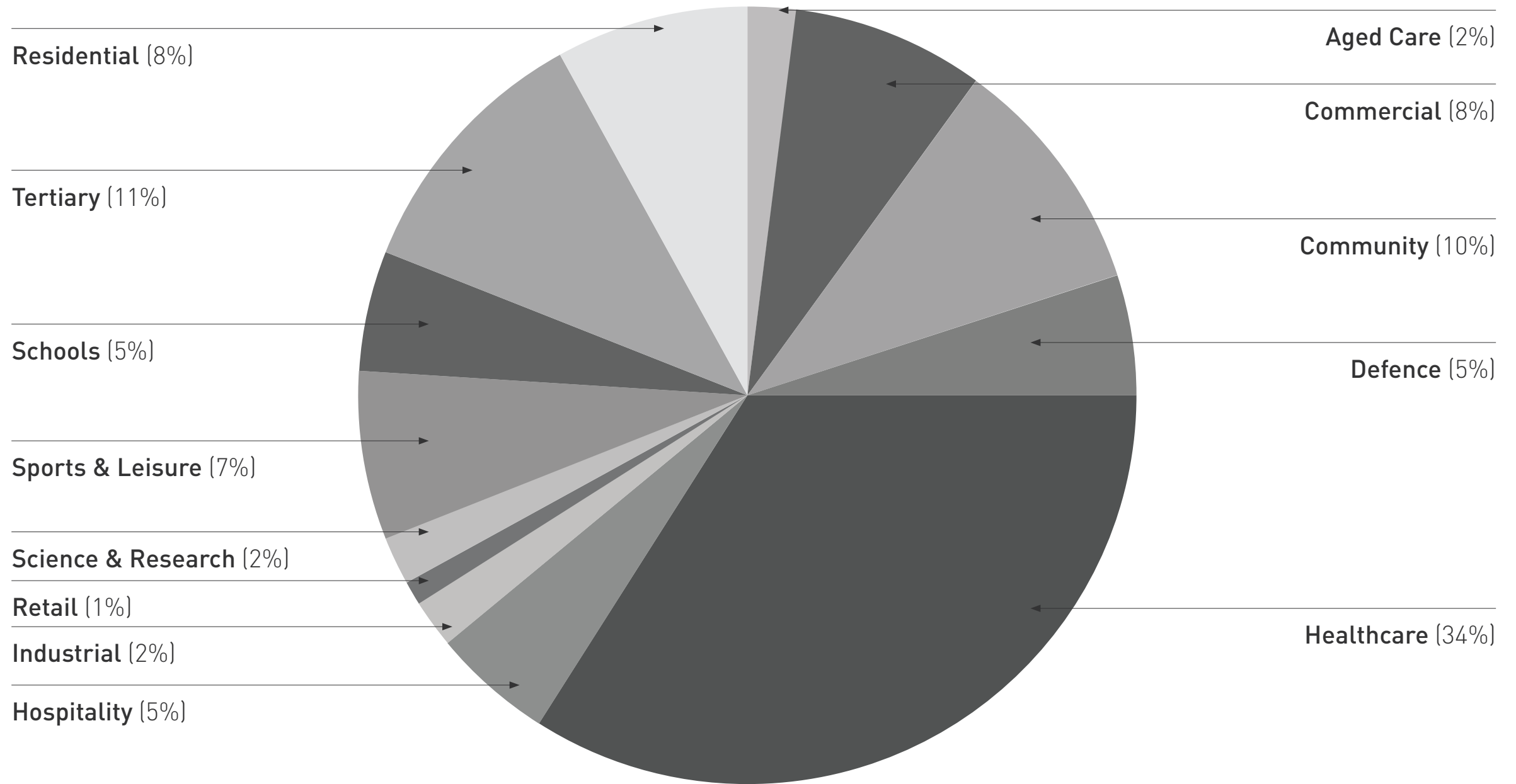

Timeline

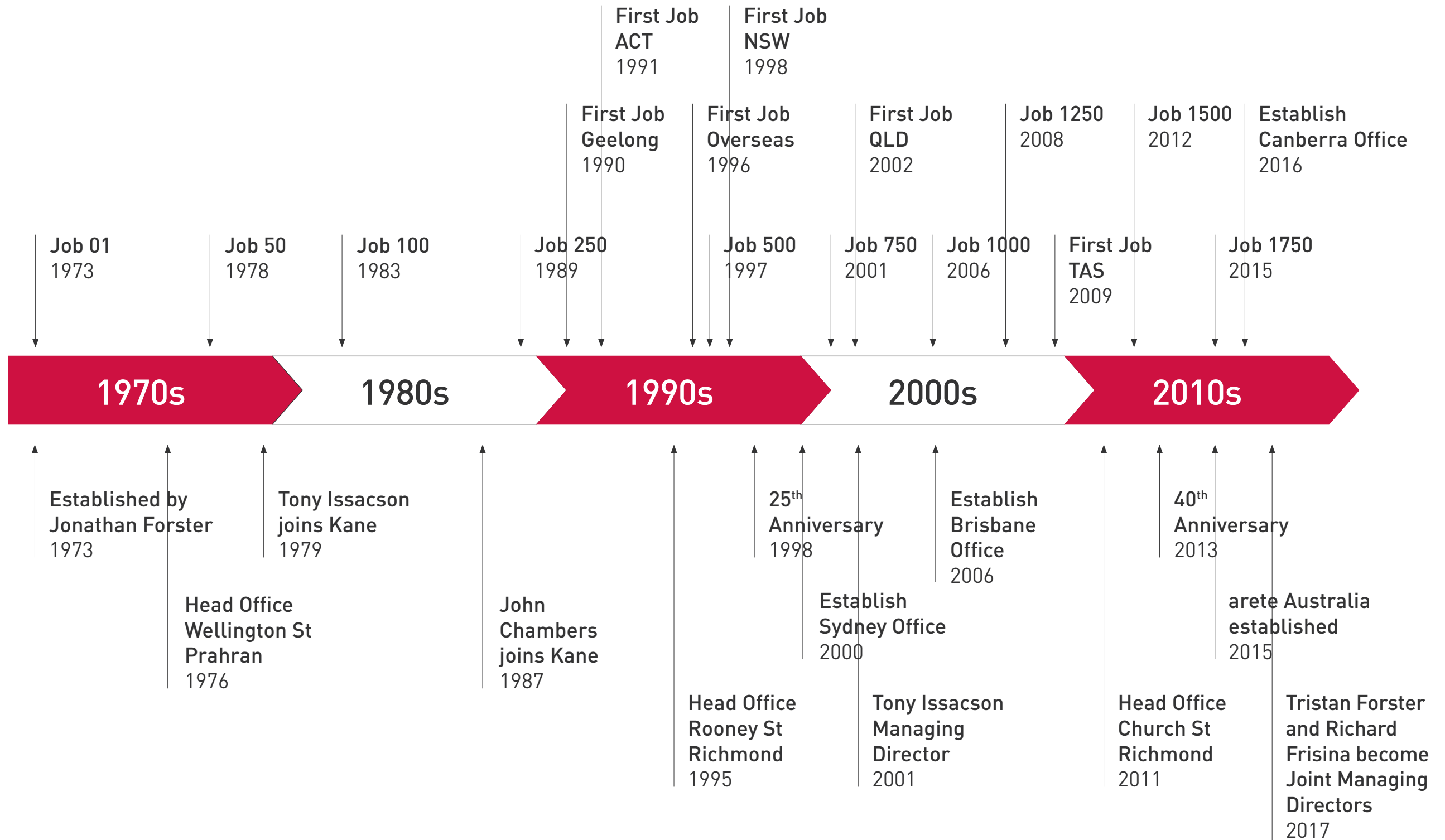

PROJECTS





SCHOOLS

Job Number: 1939 / 2017

Name: Project Archimedes

Client: Wenona School

Team: EPM Projects / Tonkin Zulaikha
Greer / NBRS+Partners

Location: New South Wales

Value: \$39m



SCHOOLS

Job Number: 1873 / 2016

Name: Science & Technology Hub

Client: Melbourne Grammar School

Team: Denton Corker Marshall

Location: Victoria

Value: \$27m

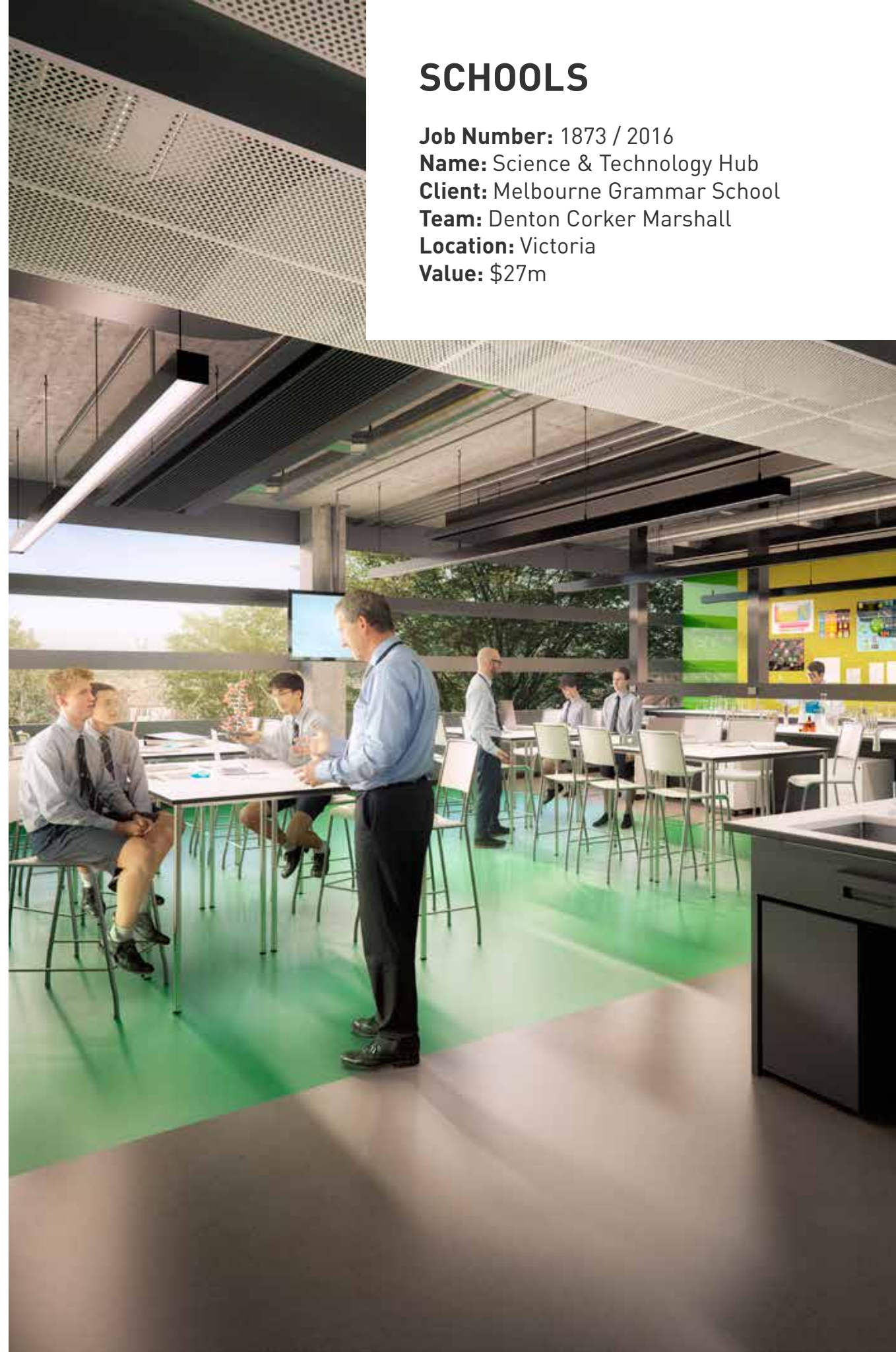

SCHOOLS

Job Number: 1858 / 2018

Name: Hermitage Project

Client: Marcellin College

Team: Montlaur Project Services / Cox
Architecture

Location: Victoria

Value: \$16m





SCHOOLS

Job Number: 1738 / 2016

Name: Artemis Project

Client: Melbourne Girls Grammar

Team: Graymatters / BVN

Location: Victoria

Value: \$23m

SCHOOLS

Job Number: 1737 / 2016

Name: Performing Arts Centre

Client: Presbyterian Ladies' College

Team: Root Projects Australia /
Cox Architecture

Location: Victoria

Value: \$30m



SCHOOLS

Job Number: 1707 / 2016

Name: Sir Zelman Cowen Centre
for Science

Client: Scotch College

Team: Cox Architecture

Location: Victoria

Value: \$32m





SCHOOLS

Job Number: 1665 / 2014

Name: Redcliffe State High School
New Year 7 Building

Client: Department of Education,
Training & Employment

Team: Point Project Management, arkLAB

Location: Queensland

Value: \$3m



SCHOOLS

Job Number: 1657 / 2014

Name: Chancellor State College,
Year 7 Building

Client: QLD Department of Education

Team: Donald Cant Watts Corke,
COBiE Group

Location: Queensland

Value: \$2m



SCHOOLS

Job Number: 1646 / 2014

Name: The Chambers

Client: Somerville House

Team: Blades Project Services,
Bickerton Masters Architecture

Location: Queensland

Value: \$3m

SCHOOLS

Job Number: 1641 / 2014

Name: Lecture Theatre

Client: Ivanhoe Girls Grammar School

Team: Jackson Architecture

Location: Victoria

Value: \$5m





SCHOOLS

Job Number: 1625 / 2014

Name: Foundation Building

Client: Somerville House

Team: Bickerton Masters Architecture

Location: Queensland

Value: \$12m



SCHOOLS

Job Number: 1586 / 2013

Name: Featherstone Hall

Client: Strathcona Baptist Girls
Grammar School

Team: PMDL Architects

Location: Victoria

Value: \$2m

SCHOOLS

Job Number: 1502 / 2012

Name: St Ives Preparatory School
Stages 1-4

Client: Sydney Grammar School

Team: Morgan Moore & Associates /
NBRSPartners

Location: New South Wales

Value: \$9m





SCHOOLS

Job Number: 1478 / 2011

Name: Worongary State School
Performing Arts Hall

Client: Department of Education,
Training & Employment

Team: Lambert & Rehbein

Location: Queensland

Value: \$2m



SCHOOLS

Job Number: 1444 / 2010

Name: Preparatory School

Client: Trinity Grammar School

Team: Thinc Projects / NBRSPartners

Location: New South Wales

Value: \$4m

SCHOOLS

Job Number: 1430 / 2011

Name: Performing Arts Centre

Client: Star of the Sea

Team: Architectus

Location: Victoria

Value: \$8m



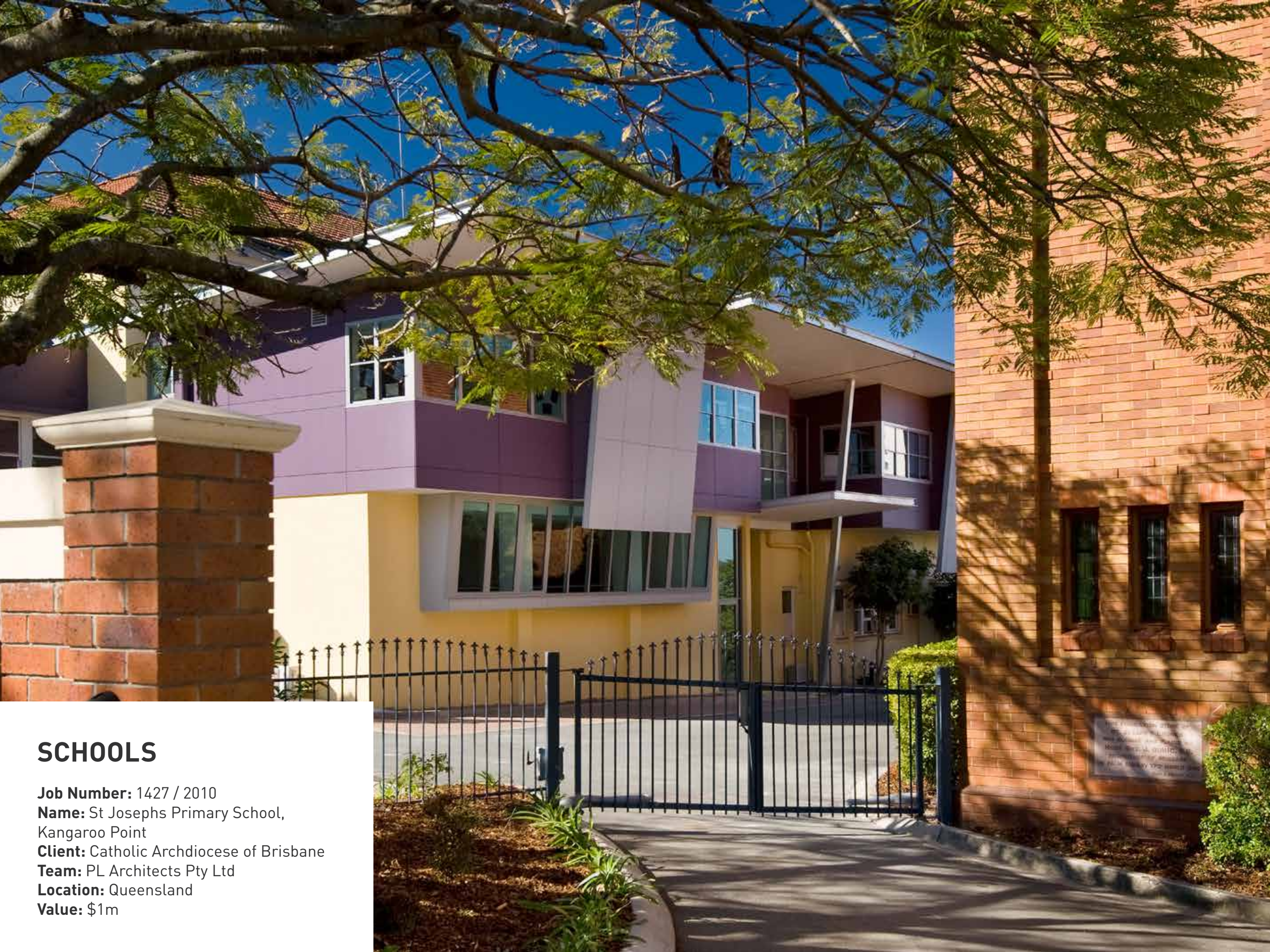

SCHOOLS

Job Number: 1427 / 2010

Name: St Josephs Primary School,
Kangaroo Point

Client: Catholic Archdiocese of Brisbane

Team: PL Architects Pty Ltd

Location: Queensland

Value: \$1m

SCHOOLS

Job Number: 1358 / 2010

Name: Nossal High School

Client: Department of Education

Team: Woods Bagot

Location: Victoria

Value: \$15m



SCHOOLS

Job Number: 1343 / 2011

Name: Crusoe Secondary College

Client: Department of Education

Team: Hassell

Location: Victoria

Value: \$20m



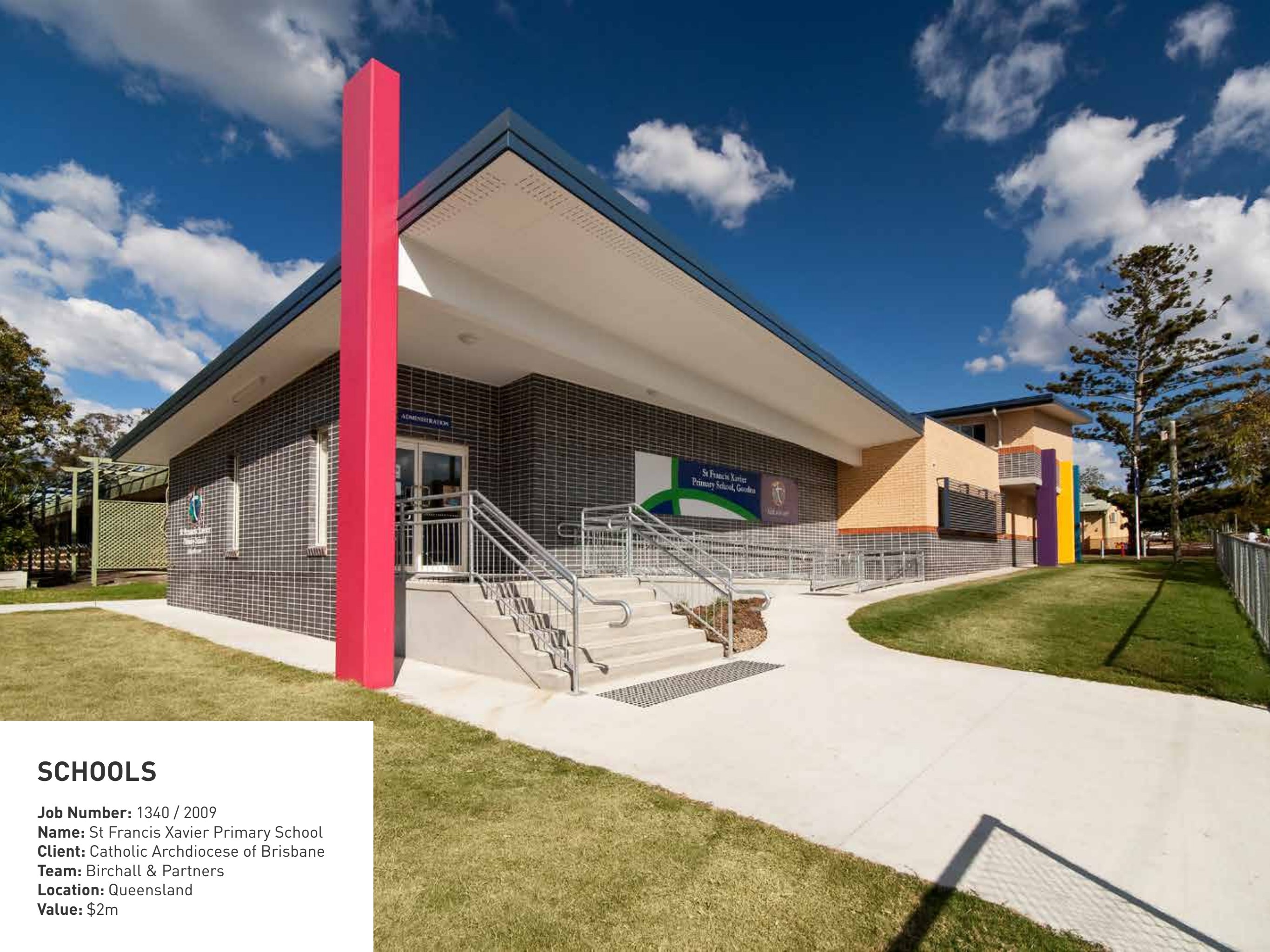

SCHOOLS

Job Number: 1340 / 2009

Name: St Francis Xavier Primary School

Client: Catholic Archdiocese of Brisbane

Team: Birchall & Partners

Location: Queensland

Value: \$2m



SCHOOLS

Job Number: 1284 / 2008

Name: Scott Street Kindergarten

Client: Department of Education,
Training & Employment

Team: Arkhefield

Location: Queensland

Value: \$1m



SCHOOLS

Job Number: 1200 / 2006

Name: Newcomb Secondary College

Client: Client to Department
of Education

Team: Haskell Architects

Location: Victoria

Value: \$7m



SCHOOLS

Job Number: 1161 / 2006

Name: Lauriston Girls School
Year 7 & 8 Wing

Client: Lauriston Girls School

Team: Davis Langdon / Hayball

Location: Victoria

Value: \$4m

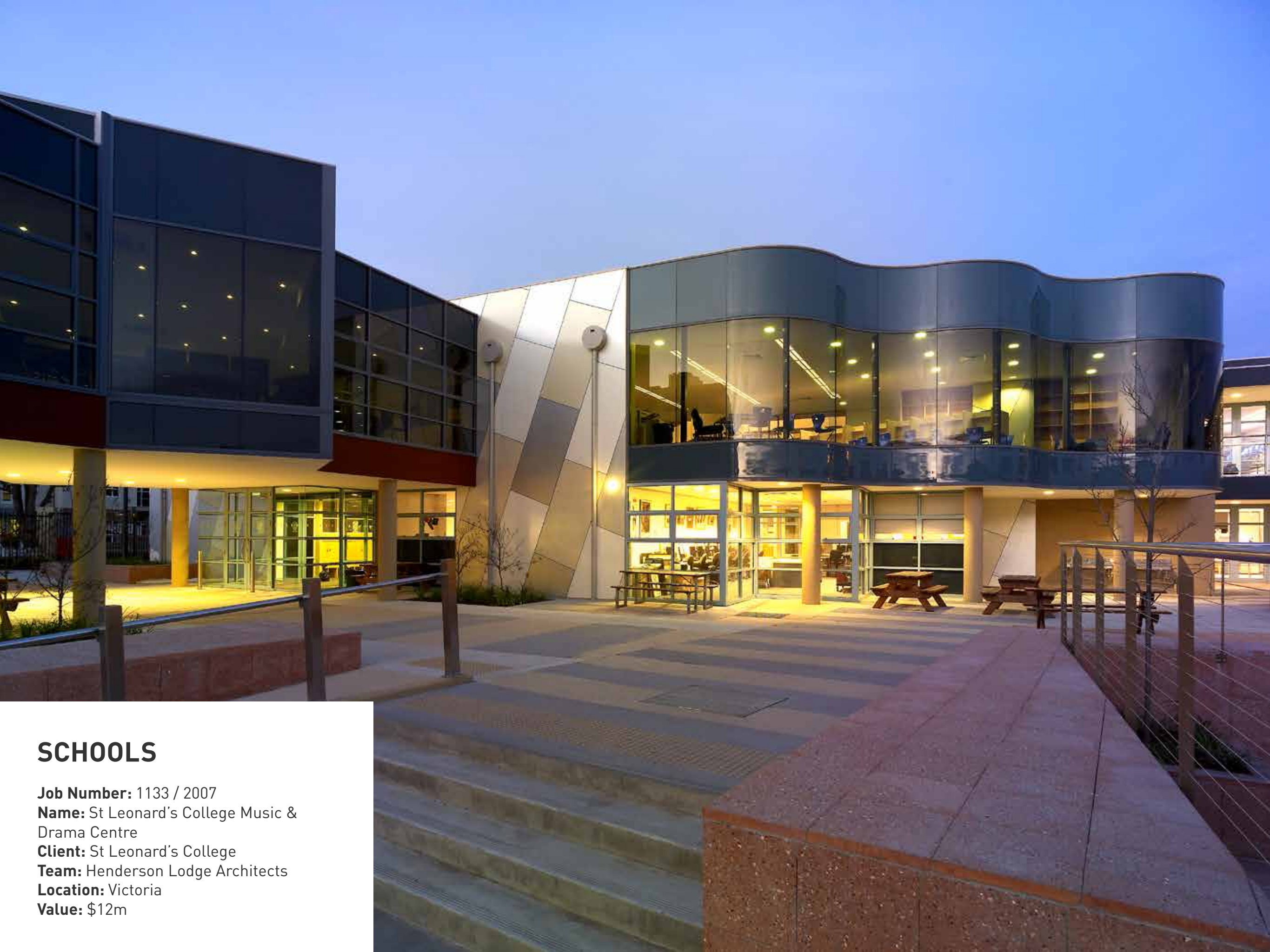

SCHOOLS

Job Number: 1133 / 2007

Name: St Leonard's College Music & Drama Centre

Client: St Leonard's College

Team: Henderson Lodge Architects

Location: Victoria

Value: \$12m



SCHOOLS

Job Number: 1084 / 2005

Name: Lecceto Arts Centre

Client: St Augustine's College

Team: EPM Projects

Location: New South Wales

Value: \$4m



SCHOOLS

Job Number: 932 / 2003
Name: Activities Centre
Client: Parade College
Team: Sweett Group /
Williams Ross Architects
Location: Victoria
Value: \$5m



SCHOOLS

Job Number: 918 / 2005

Name: Information Technology Centre

Client: Frensham School

Team: Tanner & Associates

Location: New South Wales

Value: \$4m



SCHOOLS

Job Number: 822 / 2002

Name: Science Building

Client: Woodleigh School

Team: Sean Godsell Architects

Location: Victoria

Value: \$3m

SCHOOLS

Job Number: 783 / 2002

Name: Physical Education Centre

Client: Sacred Heart College

Team: Williams Ross Architects

Location: Victoria

Value: \$2m



SCHOOLS

Job Number: 156 / 1988

Name: Senior Resource Centre

Client: Wesley College

Team: McGlashan Everist /
Jackson Architecture

Location: Victoria

Value: \$4m



Kane Constructions

kane.com.au

VICTORIA

Jonathan Angelopoulos

0430 369 499

jange@kane.com.au

NEW SOUTH WALES

Dominic Begley

0434 735 033

dbegley@kane.com.au

QUEENSLAND

Lauri Brown

0447 231 838

lbrown@kane.com.au

AUSTRALIAN CAPITAL TERRITORY

Jon Anastasov

0468 988 207

janastasov@kane.com.au